

INSTALLATION INSTRUCTIONS



THIS PRODUCT MUST BE INSTALLED IN ACCORDANCE WITH THE APPLICABLE INSTALLATION CODE BY A PERSON FAMILIAR WITH THE CONSTRUCTION AND OPERATION OF THE PRODUCT AND THE HAZARDS INVOLVED.
CE PRODUIT DOIT ETRE INSTALLE SELON LE CODE D'INSTALLATION PERTINENT, PAR UNE PERSONNE QUI CONNAIT BIEN LE PRODUIT ET SON FONCTIONNEMENT AINSI QUE LES RISQUES INHERENTS.
DISCONNECT POWER PRIOR TO ANY INSTALLATION.
DEBRANCHEZ LE COURANT AVANT TOUTE INSTALLATION.
CAP ALL WIRING CONNECTIONS WITH UL APPROVED WIRE CONNECTORS.
COUVRIR TOUTES LES CABLES AVE DES CONNECTIONS APPROUVEES (UL).
VERIFY SUPPLY VOLTAGE MEETS LUMINAIRE LABEL SPECIFICATIONS.
VERIFIEZ QUE LA TENSION SOIT COMPATIBLE AVEC LES CARACTERISTIQUES DU LUMINAIRE MARQUE SUR LETIQUETTE.
ALLOW FIXTURE TO COOL BEFORE TOUCHING HEATSINK OR LIGHT SOURCE.
LAISSEZ LE PROJECTEUR REFOIDIR AVANT DE TOUCHER LE RADIATEUR OU LA SOURCE DE LUMIERE.
DO NOT ATTEMPT TO OPEN OR MAKE REPAIRS INSIDE LUMINAIRE.
NE PAS TENTER DOUVRIRE OU DE FAIRE DES REPARATINS A L'INTERIEUR DU LUMINAIRE.
AVOID DIRECT VIEWING OF LIGHT SOURCE.
EVITEZ DE REGARDER DIRECTMENT LA SOURCE LUMINEUSE.
THIS PRODUCT MUST BE INSTALLED BY A QUALIFIED ELECTRICIAN.
CE PRODUIT DOIT ITRE INSTALLE PAR UN ELECTRICIEN QUALIFIE.
SUITABLE FOR UNDER-CABINET MOUNT.
ADAPTE POUR SOUS-CABINET MOUNT.
SUITABLE FOR DAMP LOCATION.
ADAOTE POUR DES ENDROITS HUMIDES.
SUITABLE FOR CONTINUOUS ROW MOUNTING.
ADAPTE POUR CONTINUE ROW MONTAGE.

CAUTION: The mounting means provided with this luminaire has not been evaluated for reliability. If installed where failure of the mounting means could cause injury to persons or damage to property below, supplemental means of securement should be considered.



MICRO FLAT

INSTALLATION INSTRUCTIONS

Individual T-Grid (TB1, TB2, TB3, TB4, TB5)

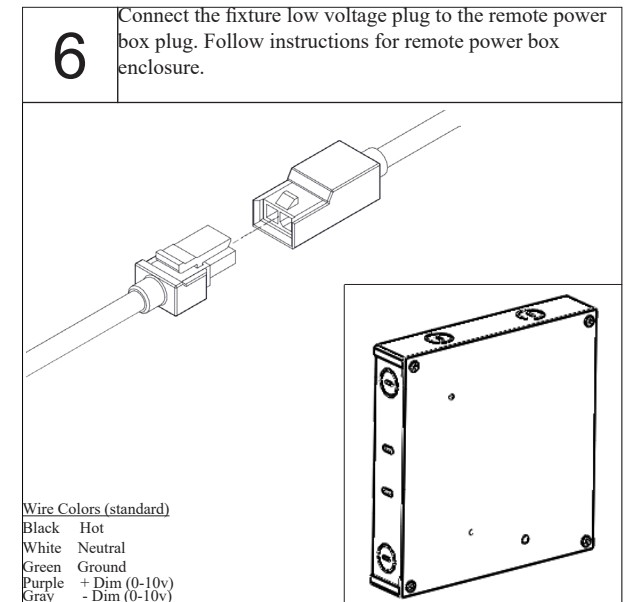
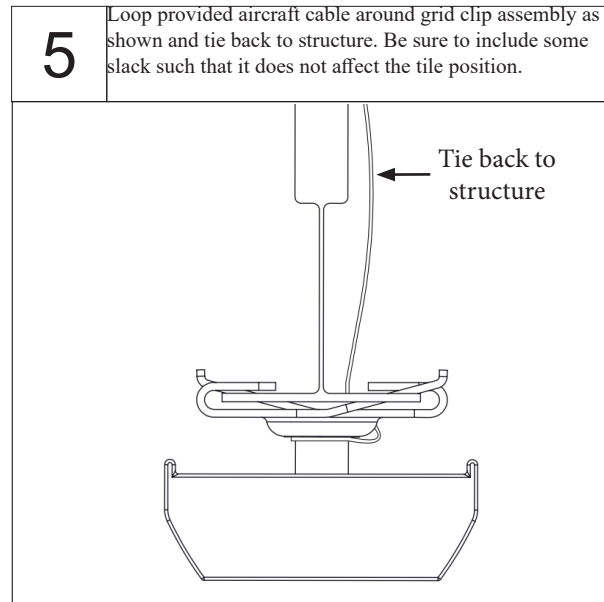
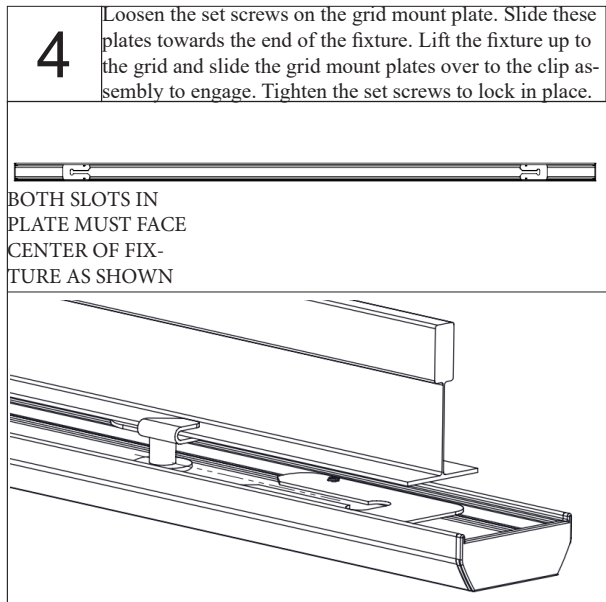
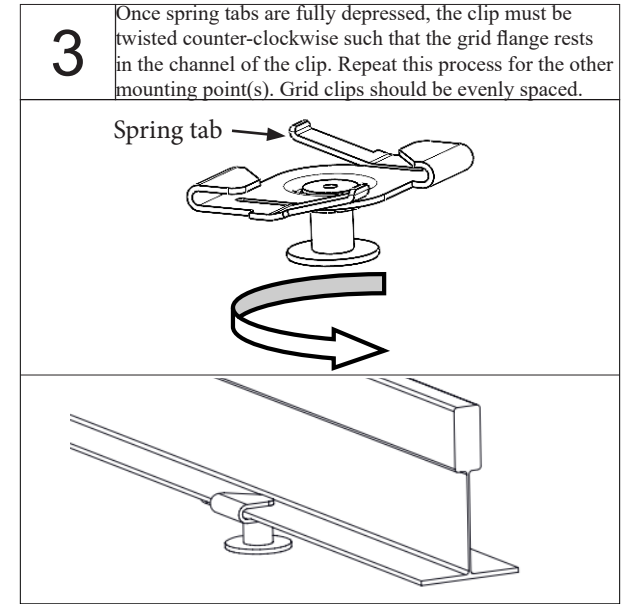
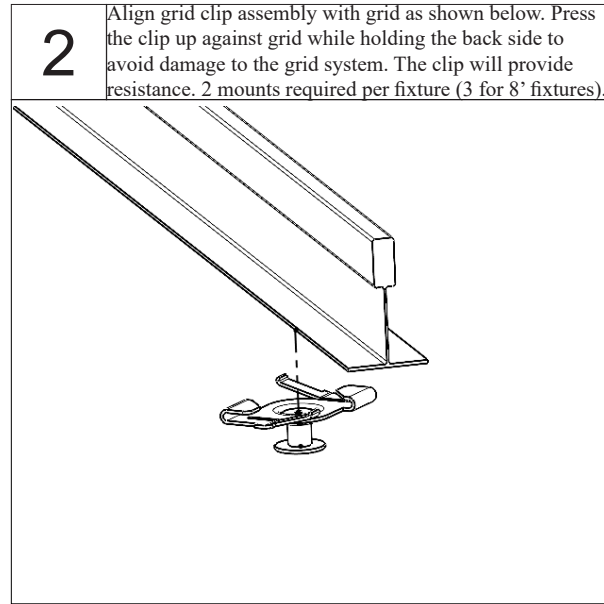
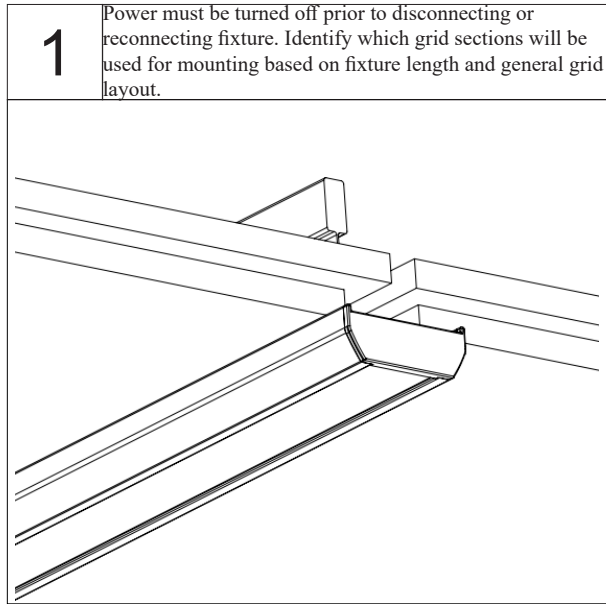

INSTALLATION INSTRUCTIONS

Continuous T-Grid (TB1, TB2, TB3, TB4, TB5)

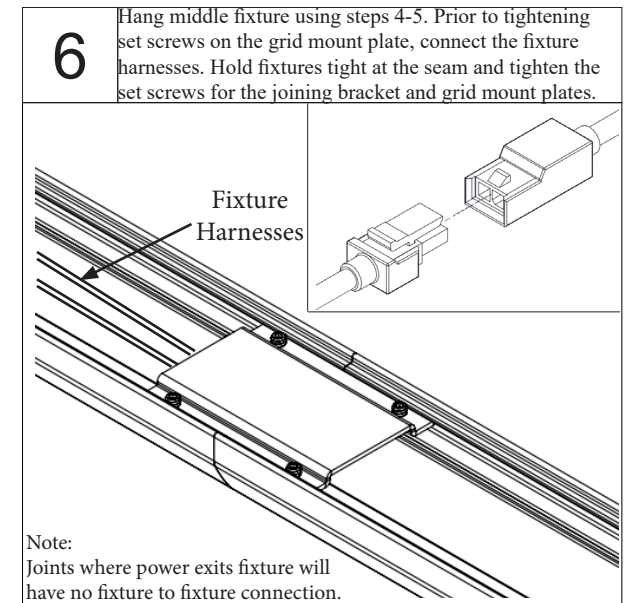
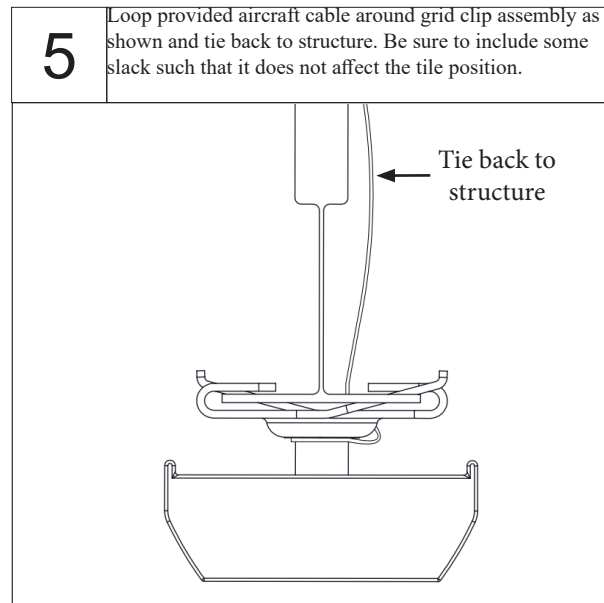
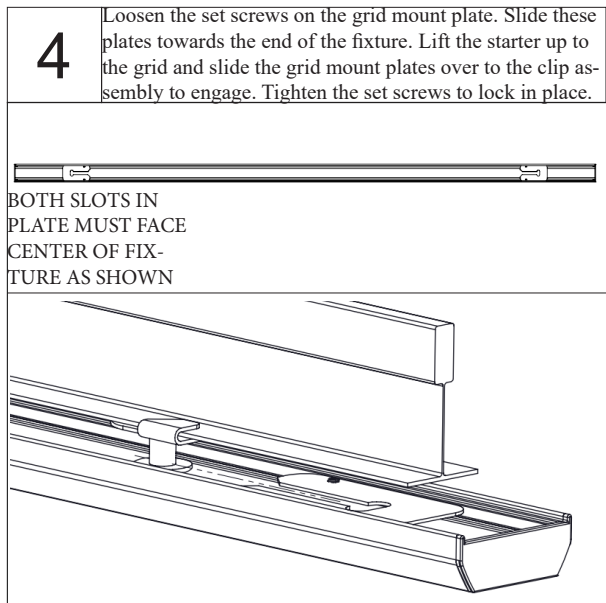
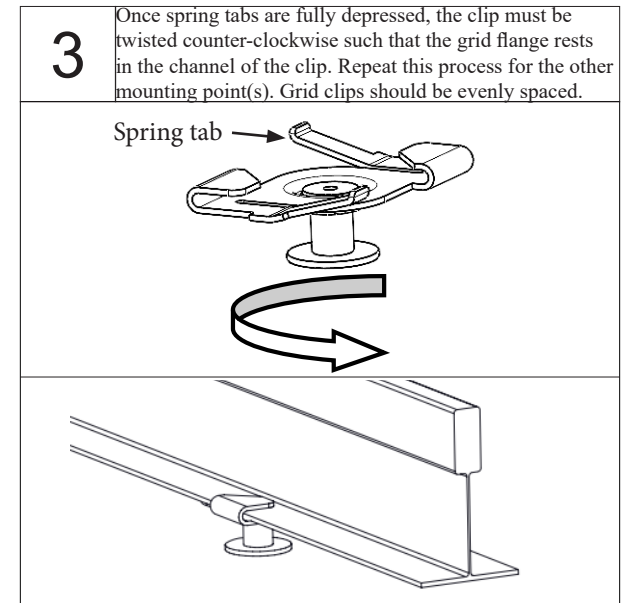
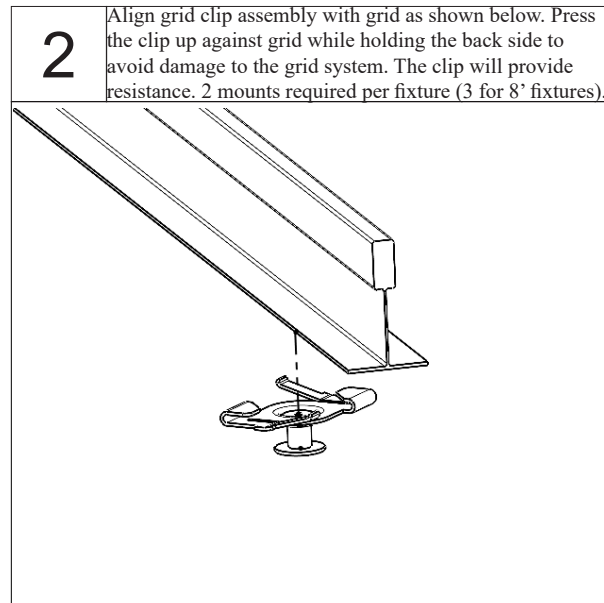
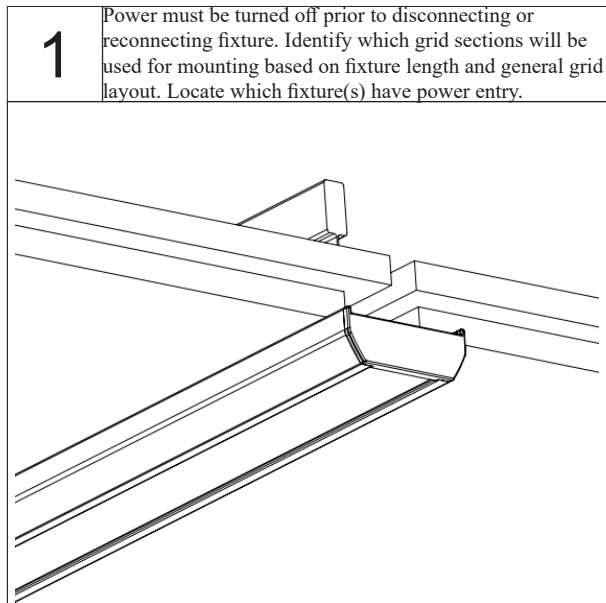

INSTALLATION INSTRUCTIONS

Continuous T-Grid (TB1, TB2, TB3, TB4, TB5)

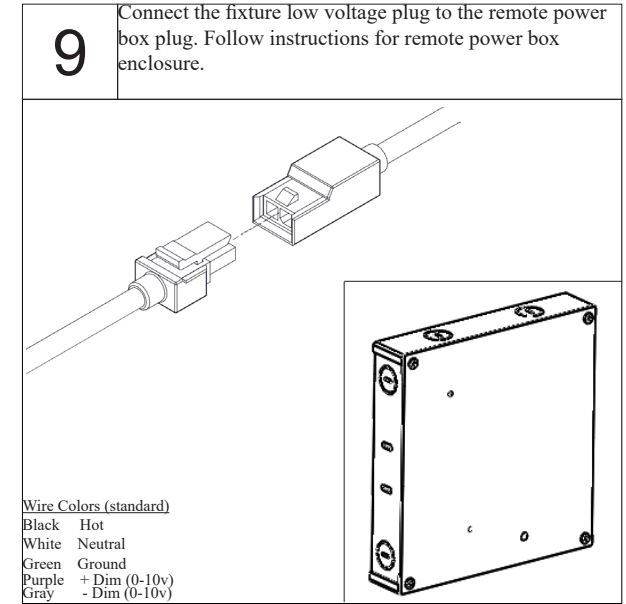
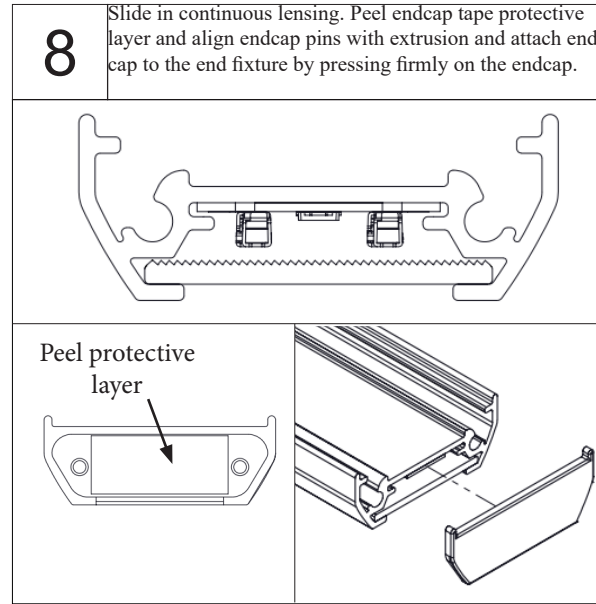
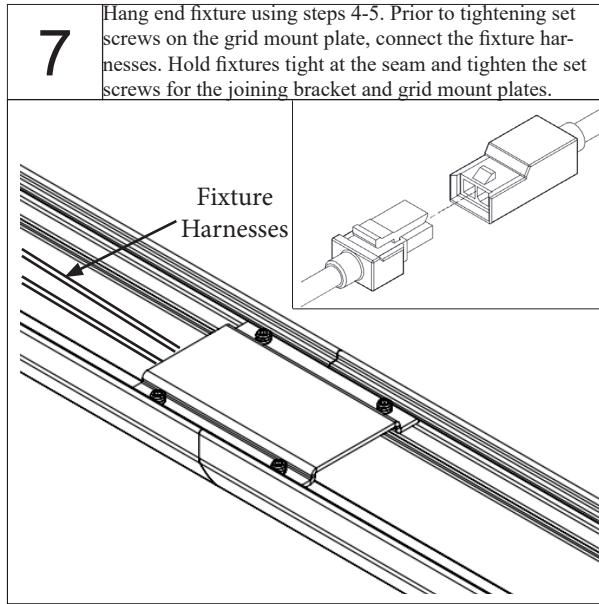

INSTALLATION INSTRUCTIONS

Continuous T-Grid (TB1, TB2, TB3, TB4, TB5) Sq or Rect

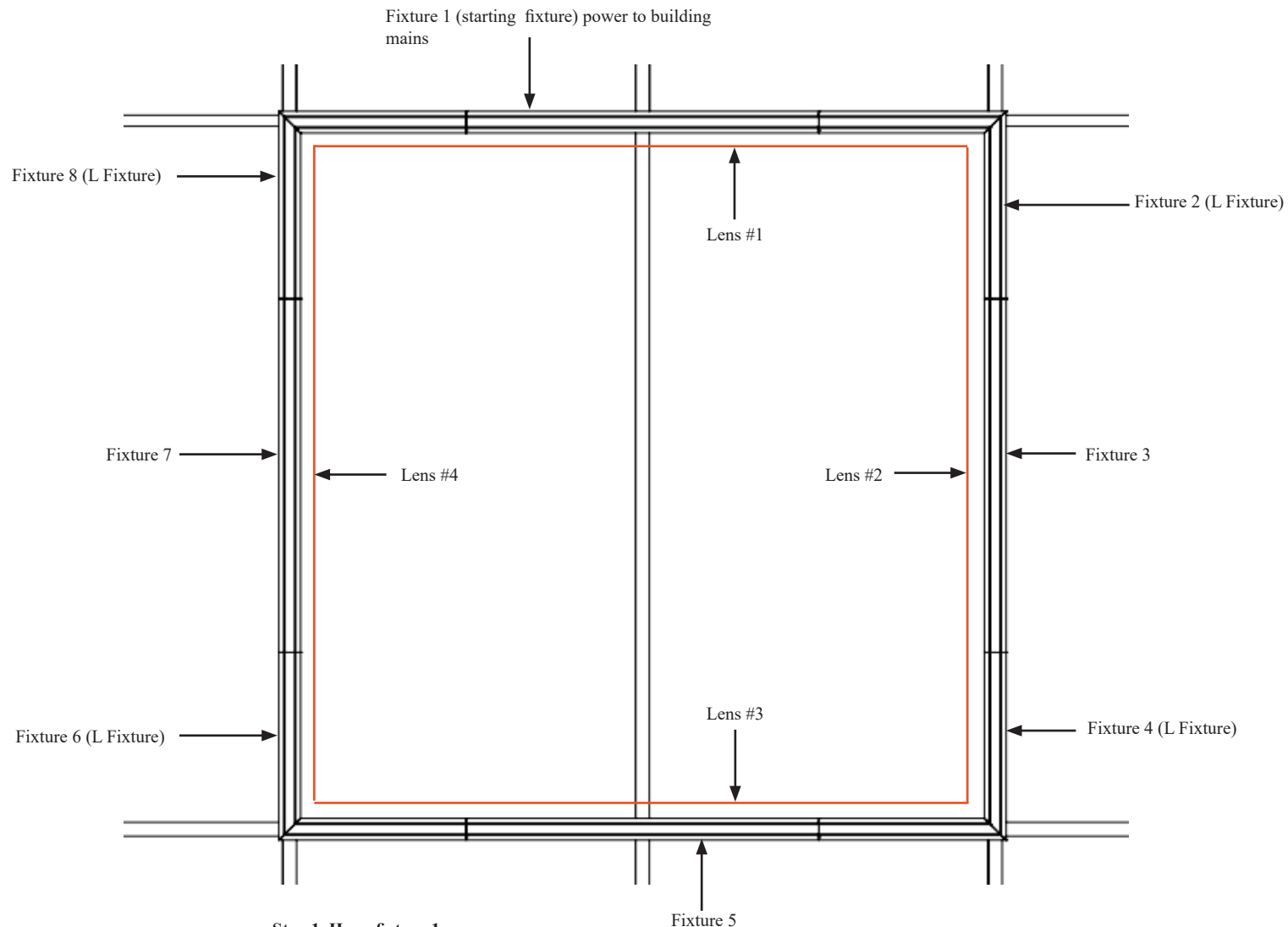

- Step 1. Hang fixture 1.**
Step 2. Hang fixture 2. Connect Fixtures 1&2. Slide in lens #1.
Step 3. Hang fixture 8. Slide in lens #1 to cap off that section and connect fixtures.
Step 4. Hang fixture 3. Connect fixtures 2&3. Slide in lens #2.
Step 5. Hang fixture 7. Slide in lens #4 and connect fixtures 7&8.
Step 6. Slide lens #3 in fixture 5. Connect fixtures 4, 5 & 6.
Step 7. Hang fixture 4, 5, & 6. Slide in lens #3 to cap off that section and connect fixtures 6&7.

Note:
Lenses provided are 1-3/32" greater than the ordered fixture length due grid center dimensions.
Ex.) 4x4SQ -> 4x 49-3/32" lenses

INSTALLATION INSTRUCTIONS

Continuous T-Grid (TB1, TB2, TB3, TB4, TB5) Sq or Rect

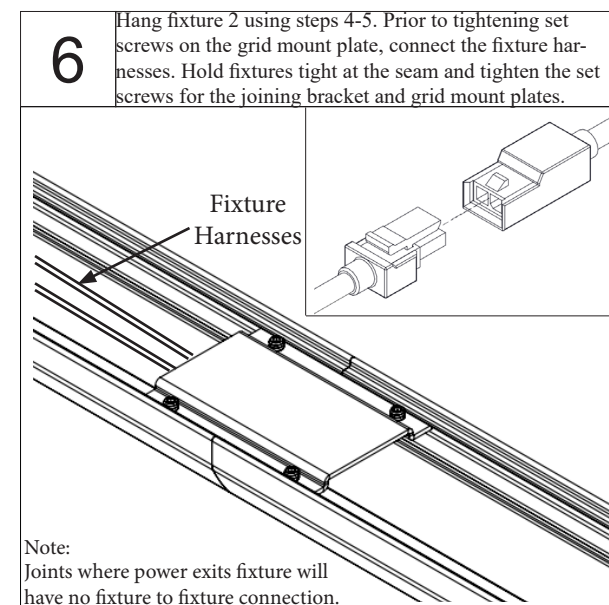
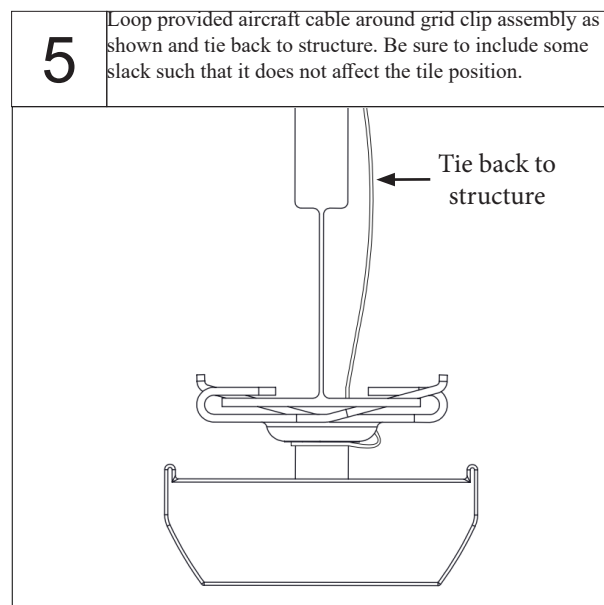
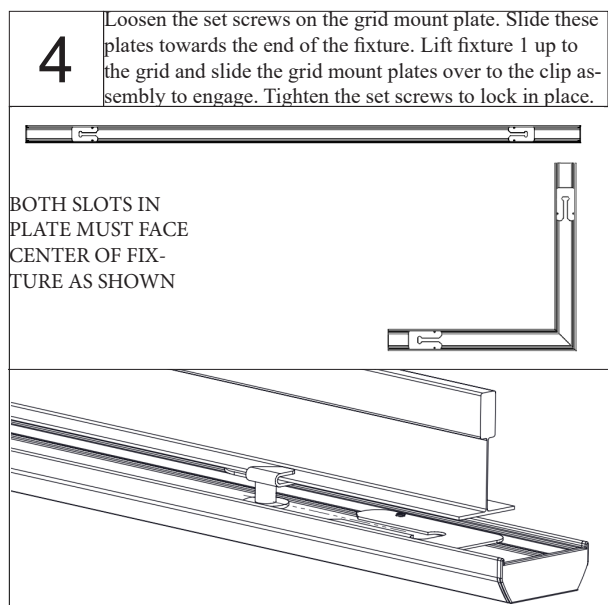
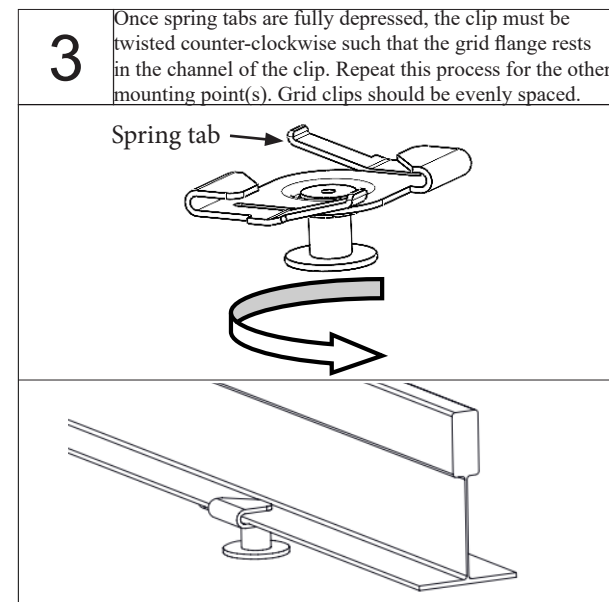
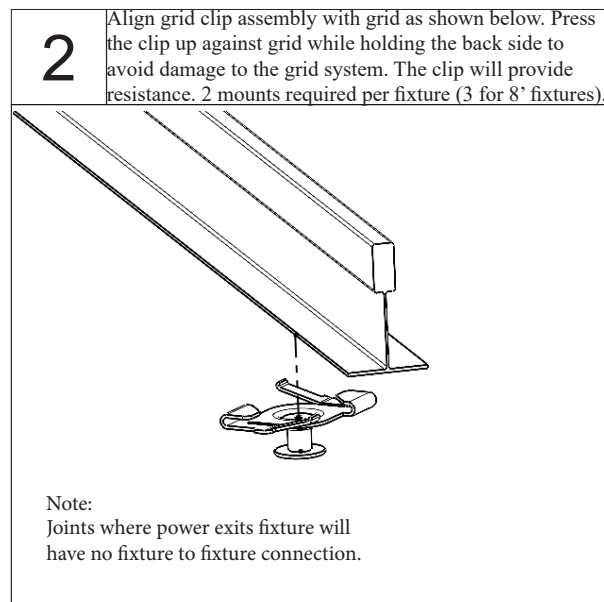
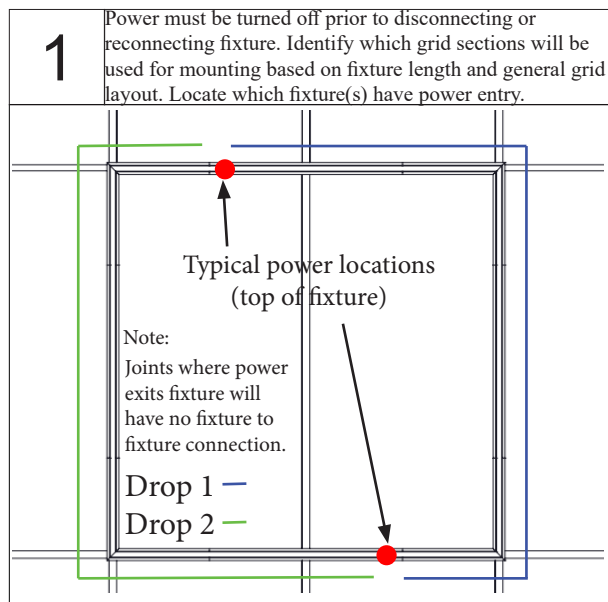

INSTALLATION INSTRUCTIONS

Continuous T-Grid (TB1, TB2, TB3, TB4, TB5) Sq or Rect

7 Slide lens #1 into the assembled fixtures 1 & 2 so that the ridges face inside the fixture. Hang Fixture 8 and connect using steps 4-6.

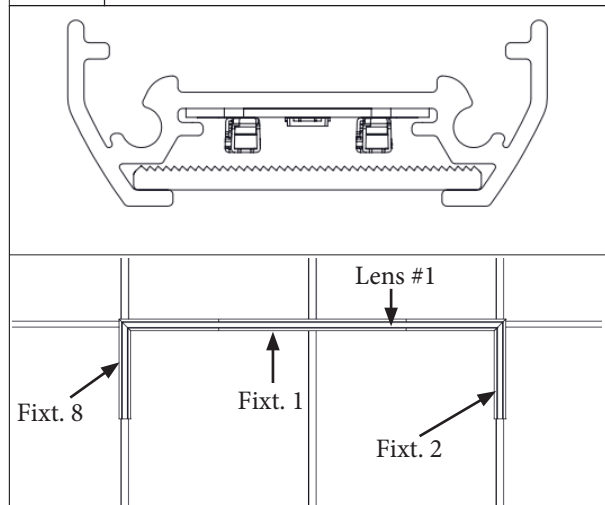

8 Hang fixtures 3 & 7. Slide in lens 2 & 4, ensuring proper orientation (see step 7).

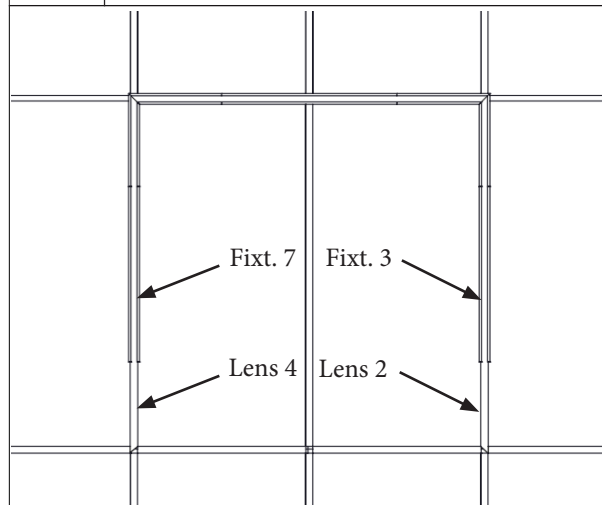

9 Connect fixture 4 & 5 using step 6. Insert lens #3. Connect fixture using step 6.

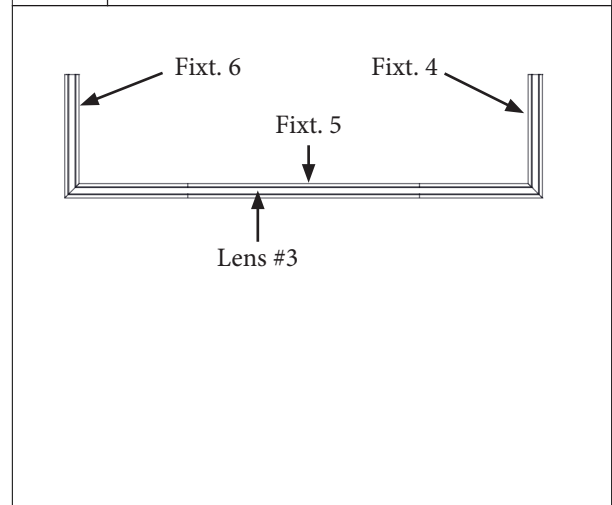

10 Lift assembled section up to ceiling. Slide lensing into the housings, and hang fixtures using steps 4-6.

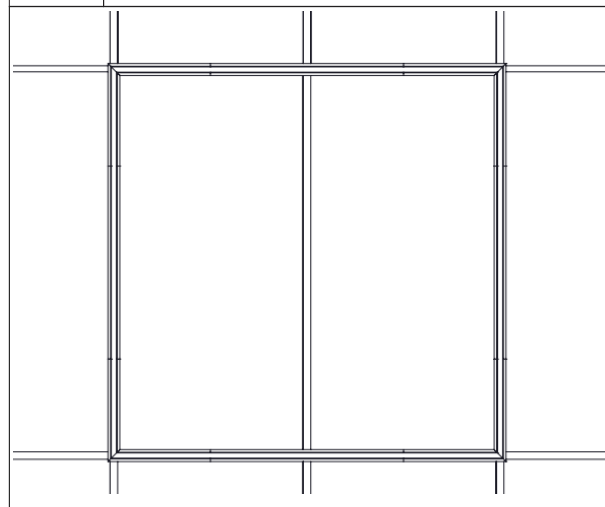

11 Connect the fixture low voltage plugs to the remote power box plug. Follow instructions for remote power box enclosure.

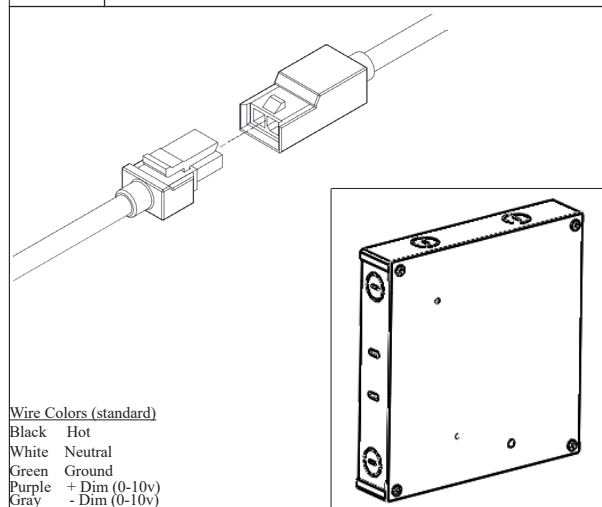

INSTALLATION INSTRUCTIONS

Remote Surface Mount Power Box (RSMx)

1

Power must be disconnected prior installing power box. Remove 4 screws to take cover (A) off of power box.

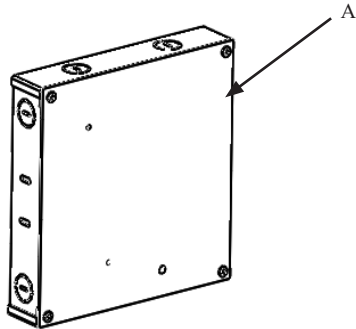

2

Determine which knockout/location the wires will exit the power box, and punch out material. Mount the power box to structure with 4 screws as shown (hardware provided by others). For power cord applications, skip to step 5

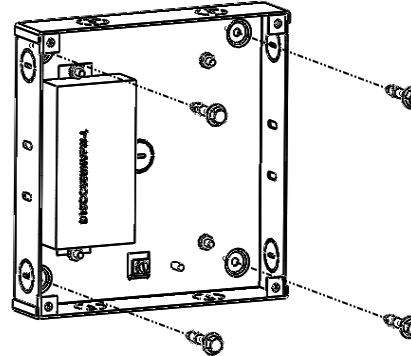

3

For conduit application: Run conduit (provided by others) from selected knockout location (B) to single gang junction box where fixture is to be mounted (fittings provided by others). Route cables through conduit to junction box.

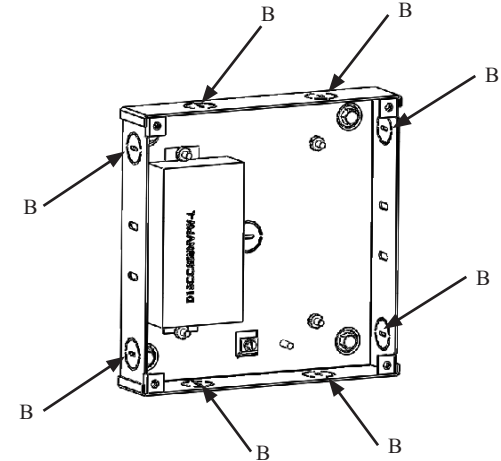

4

For power cord application: Run power cord to fixture. Connect wires to the driver (C). Power cord includes strain relief.

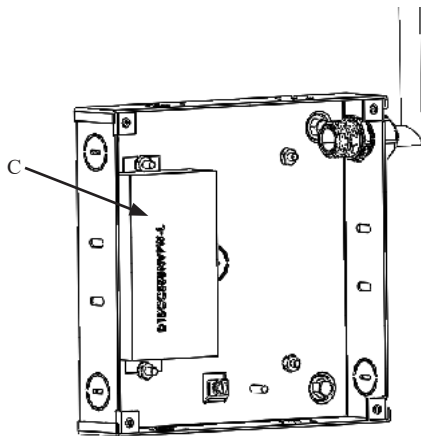

5

Connect power box to building mains. Place cover (A) back on power box, and fasten with 4 screws.

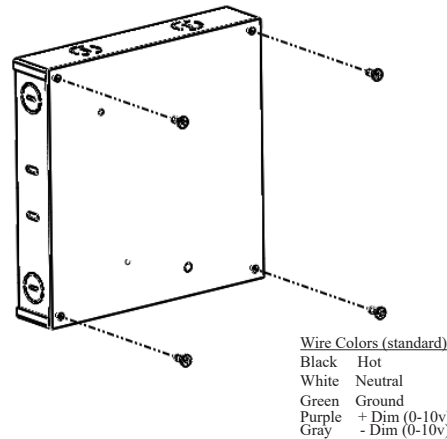

6

Restore power.

