

SLIM HUB SLIM BEAM DIRECT/INDIRECT

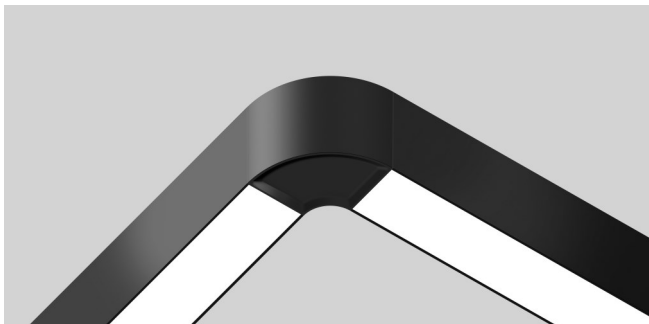

Type:	
Project:	
REP/Agent:	
Order #:	



CONFIGURATIONS

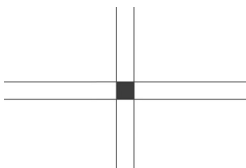

'X' Sharp Hub

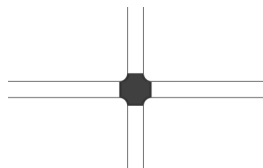

'X' Curved Hub

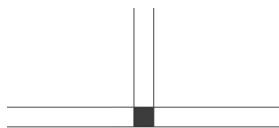

'T' Sharp Hub

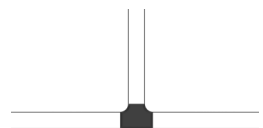

'T' Curved Hub



'L' Sharp Hub

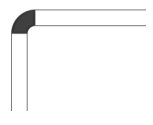

'L' Curved Hub



'I' Sharp Hub



'I' Curved Hub



'E' Sharp Hub



'E' Curved Hub

FEATURES

- ★ Continuous lensing standard– runs up to 200'
- ★ Extruded aluminum single piece housing
- ★ Standard 2', 4', 6' and 8' units, or continuous rows
- ★ Linear runs with proprietary joiner design
- ★ Light levels can be set at the factory
- ★ Efficacy up to 135 lm/W
- ★ Soft diffuse direct lighting
- ★ Textured powder coat finishes available in white, black and silver
- ★ Premium finishes also available
- ★ Approved for dry and damp locations
- ★ 0-10v dimming is standard
- ★ Dim to 1% of output current is standard
- ★ 90 CRI (R9 50min) available
- ★ CA Title 24 / JA8 installation compatible
- ★ Consult factory for TM21, TM30, LM79 and LM80

DIMENSIONS

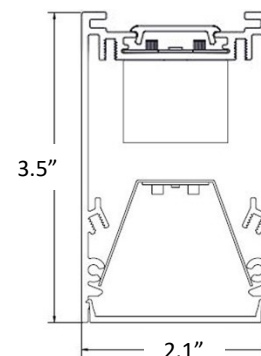

Type:	
Project:	
REP/Agent:	
Order #:	

SLIM HUB SLIM BEAM DIRECT/INDIRECT

LINEAR SLIM ORDER GUIDE

SLIMDIH-							
SERIES	LENGTH	DIRECT LUMENS PER FOOT	INDIRECT LUMENS PER FOOT	DIRECT DISTRIBUTION	INDIRECT DISTRIBUTION	CCT	CRI
SLIMDIH-	xx= Run Length	350= 350 LPF 500= 500 LPF 750= 750 LPF 1000= 1000 LPF XXX= Custom LPF	350= 350 LPF 500= 500 LPF 750= 750 LPF 1000= 1000 LPF XXX= Custom LPF	SD= SatinIce Diffuse WD= Wide Diffuse WW= Wall Wash	CL= Clear Lens BW= Batwing	30K= 3000K 35K= 3500K 40K= 4000K	80= 80 90 = 90

FINISH	MOUNTING	VOLTAGE	ELECTRICAL	FIXTURE TYPE	OPTIONS
STANDARD PW= Powder Coat White PB= Powder Coat Black PS= Powder Coat Silver	CABLES WITH CANOPY KITS ACW05= White Cord 5' ACW10= White Cord 10' ACB05= Black Cord 5' ACB10= Black Cord 10' CABLES WITH LOOPS ALW10= White Cord 10' ALB10= Black Cord 10'	U= 120-277 C= 347	1C= Single Circuit 2C= Separate D/I Circuits <i>(separate control of direct and indirect)</i> MC= Multiple Circuits <i>(multiple switch legs across run length)</i> EC= Emergency Circuit <i>(separate power drops for EC fixtures)</i> GTD= Generator Transfer Device	S = Start M = Middle E = End	BATTERIES #1EMB6= 6W EM Battery (Iota/Bodine) #1EMB10=10W EM Battery (Iota/Bodine) SENSORS DMxx%= Daylight/Motion Sensor <i>(xx%= % Min. Dimming)</i> VDO= Lutron Vive Integral fixture control <i>(RF w/ daylight and occupancy)</i> AWN-R-W= Lutron Athena Wireless Node <i>(RF only)</i> ³ - White Finish AWN-R-B= Lutron Athena Wireless Node <i>(RF only)</i> ³ - Black Finish AWNS-W= Lutron Athena Wireless Node with Sensor - White Finish AWNS-B= Lutron Athena Wireless Node with Sensor - Black Finish NLA= Acuity nLight Air WVL= Cooper Wavelinx

EXAMPLE: SLIMDIH-13-500-500-SD-BW-30K-90-PW-ACW05-U-1C-P

HUB ORDER GUIDE

SHUB			
SERIES	SHAPE	FINISH	MOUNTING
SHUB	CURVED HUBS CLxxx= 'L' Hub CTxxx= 'T' Hub CXxxx= 'X' Hub Clxxx= 'l' Hub CExxx= 'E' Hub SHARP HUBS SLxxx= 'L' Hub STxxx= 'T' Hub SXxxx= 'X' Hub Slxxx= 'l' Hub SExxx= 'E' Hub END CAPS PF= Regular Flat Replace xxx with inside angle from 0 to 180 degrees.	STANDARD PW= Powder Coat White PB= Powder Coat Black PS= Powder Coat Silver PREMIUM RALxxxx= Powder Coat RAL xxxx (Gloss Finish) CUSTOM PO= Powder Other	S= Surface Mount P= Pendant Mount G= T-grid Mount

EXAMPLE: SHUB-SL-PB-P

Job Name: _____

PO#: _____ Quote#: _____



How to use this guide

Fill out the worksheet to specify your requirements for your configurations.
Be sure to callout battery and sensor locations.

Refer to the run chart for standard run configurations on linear lengths,
consult factory for custom configurations.

Use the order guide to create your BOM for your configuration.

Submit the worksheet along with your order.

#1 Example Bill of Materials

Qty. Type

1	SLIMDIH-10-500-500-SD-CL-30K-90-PW-ACW05-U-1C-S	
3	SLIMDIH-10-500-500-SD-CL-30K-90-PW-ACW05-U-1C-M	
4	SHUB-SL-PB-P	

#2 Example Bill of Materials

Qty. Type

1	SLIMDIH-8-500-500-SD-CL-30K-90-PW-ACW05-U-1C-S	
3	SLIMDIH-8-500-500-SD-CL-30K-90-PW-ACW05-U-1C-E	
4	SHUB-SI-PB-P	
1	SHUB-SX-PB-P	

#3 Example Bill of Materials

Qty. Type

1	SLIMDIH-6-500-350-SD-CL-30K-90-PW-ACW05-U-1C-S	
11	SLIMDIH-6-500-350-SD-CL-30K-90-PW-ACW05-U-1C-M	
4	SHUB-SL-PB-P	
4	SHUB-ST-PB-P	
1	SHUB-SX-PB-P	

#4 Example Bill of Materials

Qty. Type

1	SLIMDIH-08-500-500-SD-CL-30K-90-PW-ACW05-U-1C-S	
2	SLIMDIH-04-500-500-SD-CL-30K-90-PW-ACW05-U-1C-M	
1	SLIMDIH-08-500-500-SD-CL-30K-90-PW-ACW05-U-1C-M	
1	SLIMDIH-08-500-500-SD-30K-90-PW-ACW05-U-1C-M-1EMB6	
1	SLIMDIH-06-500-500-SD-CL-30K-90-PW-ACW05-U-1C-E	
2	SHUB-SL-PB-P	
2	SHUB-ST-PB-P	
2	SHUB-SI-PB-P	

#1 Example Configuration

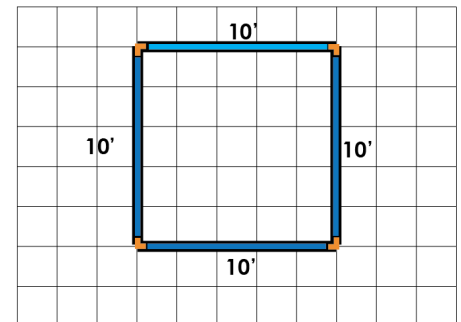

#2 Example Configuration

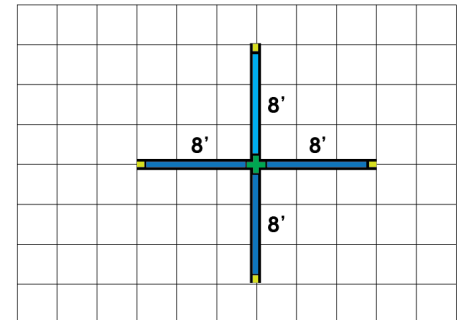

#3 Example Configuration

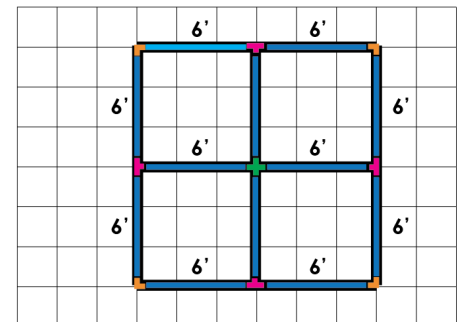

#4 Example Configuration

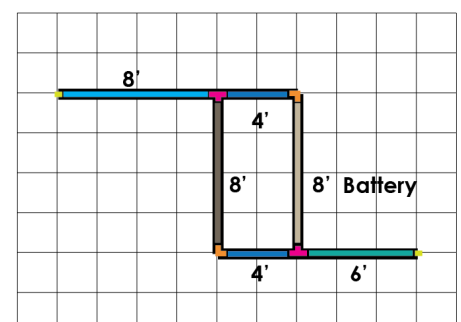

Job Name: _____

PO#: _____ Quote#: _____



Submit the worksheet along with your order.

Bill of Materials

Qty.	Type
------	------

[illegible][illegible]

Non Power Feed Canopy

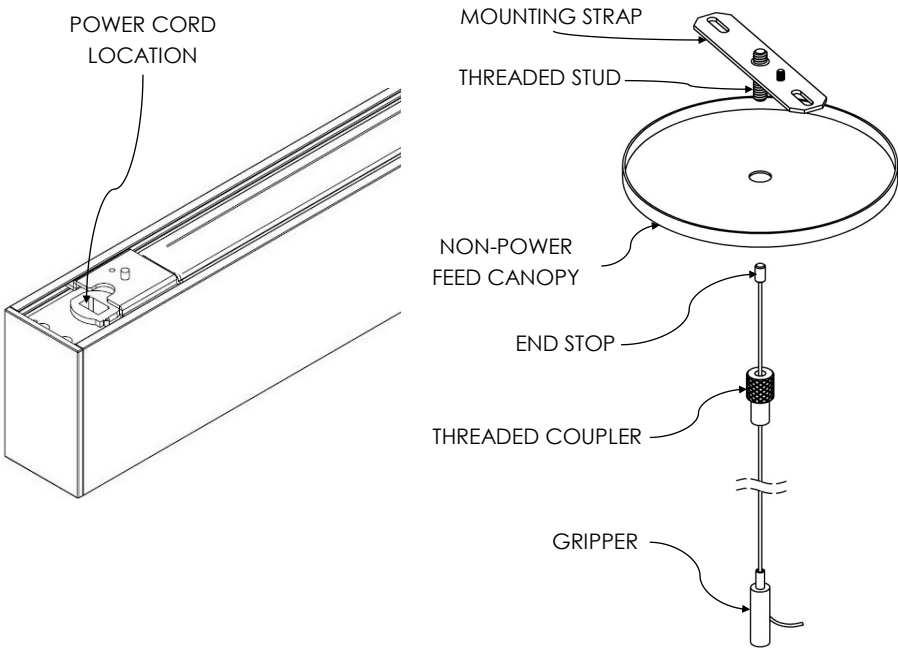

Power Feed Canopy

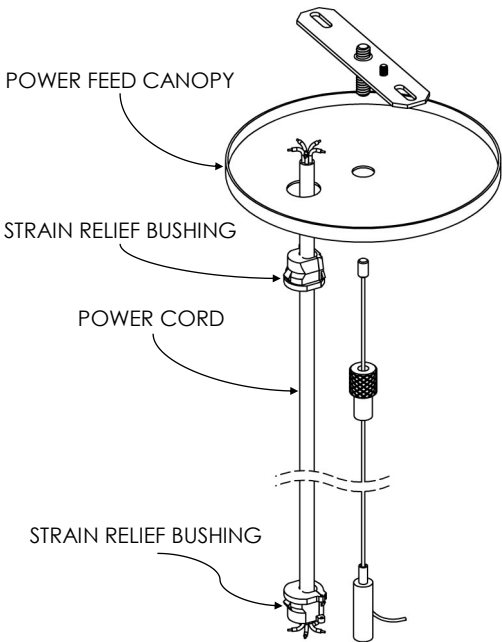

ALxxx (Aircraft Cable with Loops)

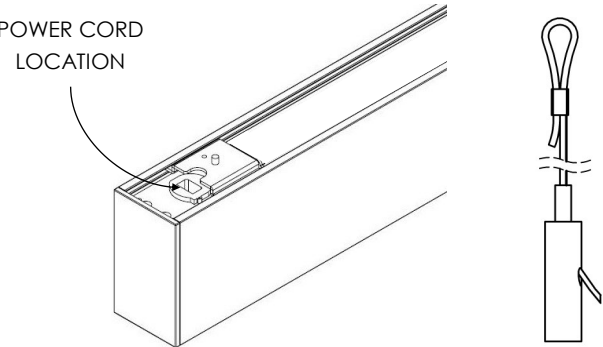

POWER CORD & FIRST MOUNT DETAIL

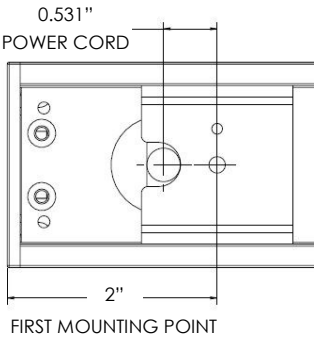

Type:	
Project:	
REP/Agent:	
Order #:	

SLIM HUB SLIM BEAM DIRECT/INDIRECT

END CAP OPTIONS

Flat Endcap

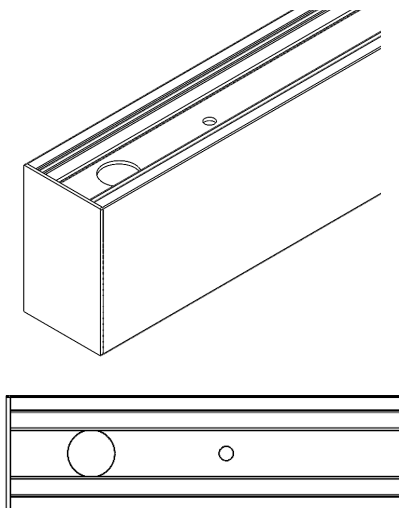

E Sharp Endcap

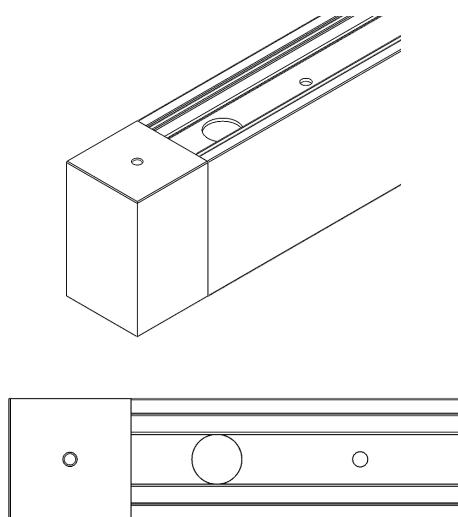

E Curved Endcap

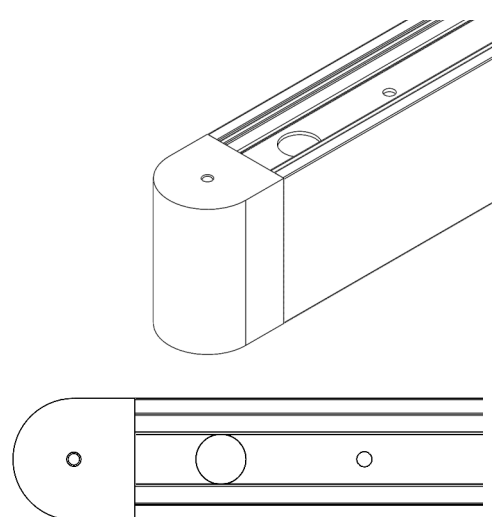

PERFORMANCE

SLIMDIH-X-325-750-WD-BW (80+ CRI)

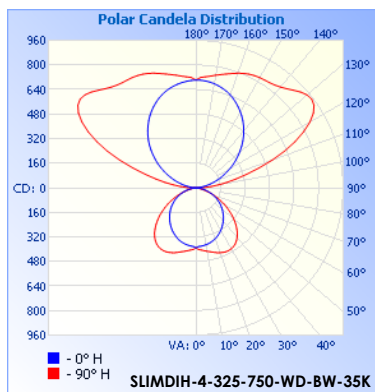

Model	Lumens	Watts	LPW
SLIMDIH-4-325-750-WD-BW-30K	4300	37	116
SLIMDIH-4-325-750-WD-BW-35K	4300	36	120
SLIMDIH-4-325-750-WD-BW-40K	4300	35	124
SLIMDIH-4-325-750-WD-BW-50K	4300	34	126

Model	Lumens	Watts	LPW
SLIMDIH-8-325-750-WD-BW-30K	8600	72	119
SLIMDIH-8-325-750-WD-BW-35K	8600	71	121
SLIMDIH-8-325-750-WD-BW-40K	8600	68	127
SLIMDIH-8-325-750-WD-BW-50K	8600	67	128

SLIMDI-X-400-375-SD-CL (80+ CRI)

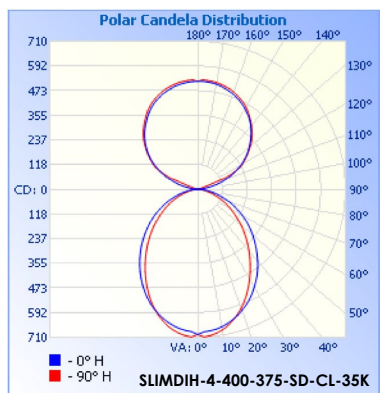

Model	Lumens	Watts	LPW
SLIMDIH-4-400-375-SD-CL-30K	3,025	25	122
SLIMDIH-4-400-375-SD-CL-35K	3,025	24	128
SLIMDIH-4-400-375-SD-CL-40K	3,025	23	132
SLIMDIH-4-400-375-SD-CL-50K	3,025	23	134

Model	Lumens	Watts	LPW
SLIMDIH-8-400-375-SD-CL-30K	6,050	47	128
SLIMDIH-8-400-375-SD-CL-35K	6,050	45	134
SLIMDIH-8-400-375-SD-CL-40K	6,050	44	138
SLIMDIH-8-400-375-SD-CL-50K	6,050	43	141

FINISHES

STANDARD FINISHES



WHITE MINI TEXTURE

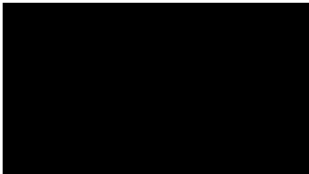

BLACK MINI TEXTURE



SILVER SPARKLE TEXTURE

PREMIUM STOCK FINISHES



PSF001 (WOOD#1)

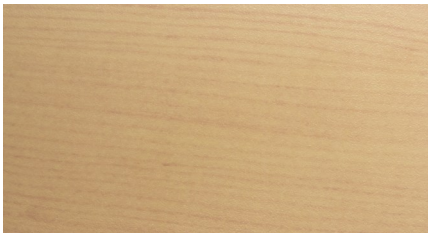

PSF002 (WOOD#2)

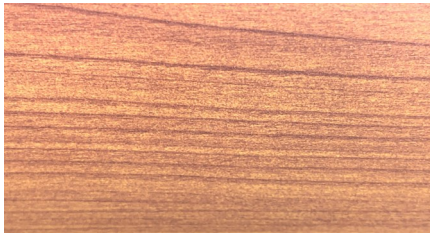

PSF003 (WOOD#3)

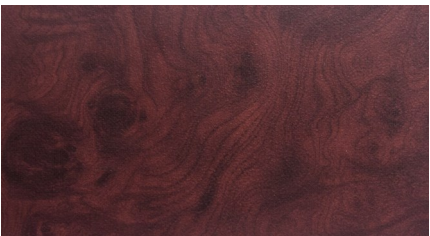

PSF004 (WOOD#4)



PSF005 (WOOD#5)

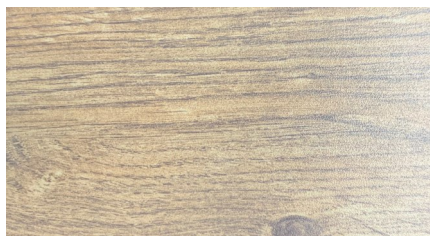

PSF006 (WOOD#6)



PSF007 (STONE #1)



PSF008 (STONE #2)

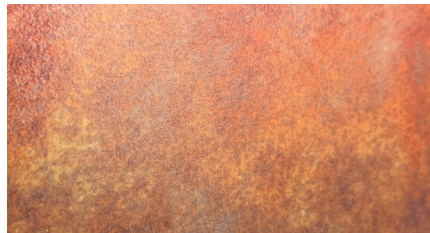

PSF009 (METAL #1)

NOTE: A minimal impact to lead times will apply to products specified with Premium Stock Finishes (PSF). It is not to be assumed that these finishes are stocked in our warehouse, but rather, are readily available to us for your project. All other custom finishes (PO) will incur a set up fee and will add an extended lead time to your project.

SLIM HUB SLIM BEAM DIRECT/INDIRECT

SPECIFICATIONS

Housing

Nominal 2.0" x 3.5" x .075" thick housing of continuous extruded 6063 T5 aluminum.

Color

Colors for the housing are available in a powder coated white, black, silver and woodgrain with end cap to match. Consult factory for custom colors.

Luminaire Length

2', 4', 6' or 8' lengths are available for a single stand-alone section. Using internal joiners, these sections can be joined to form longer rows.

End Caps

Injection molded flat end caps are mechanically attached with no exposed fasteners to enhance architectural aesthetic and prevent light leak.

Source

Lumen packages are available in four color temperature options (3000K, 3500K, 4000K and 5000K) — all within 3 MacAdam ellipses.

Certification

Intertek cETLus Listed. RoHS (Restriction of Hazardous Substances) and Buy American Act compliant.

Battery

Lithium ion battery providing up to 780lm(6W) or up to 1300lm(10W) for 90 minutes. UL924 listed. Class 2 compliant. Meets Title 20 CEC (California Energy Commission) efficiency standards.

Lensing

0.080" thick impact resistant acrylic lensing.

Environment

Suitable for dry and damp locations.

Operating temp.: -40°C to +50°C

-40°F to +122°F

Dimming Driver (Integral Driver)

Constant current programmable LED driver. UL listed, class P, 0-10V, dim to 1% of output current. 2.5KV ring wave surge protection and >.90 power factor.

Packaging

Sustainably manufactured outside cardboard box and biodegradable, protective poly-foam luminaire inserts.

CONTROL

Sensor

Wattstopper FS-205 v2 Low Voltage PIR. Integrated photosensor for hold-off daylighting control. 24VDC operating voltage. Adjustable time delay (30 seconds to 30 minutes).

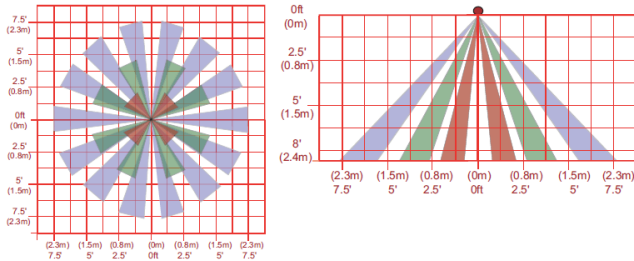

Wireless Node

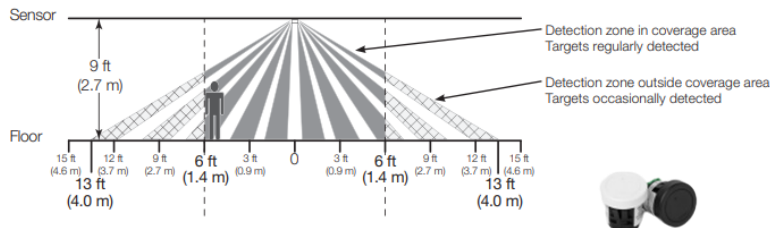

COMPANION PRODUCTS

Slim Beam Direct



Slim Beam Surface Mount



Recessed Slim Beam

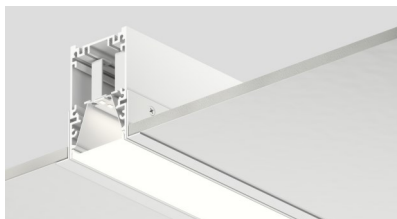

WARRANTY

5-year limited warranty. Complete warranty terms can be located at:

http://www.starteklightingamerica.com/images/pdf/warranty/Beam_Series_Warranty.pdf

Note: Actual performance may differ as a result of installation environment and final application.

All values are design or typical values, measured under laboratory conditions, at 25°C (77°F) .