

Type:	
Project:	
REP/Agent:	
Order #:	

## WAVE

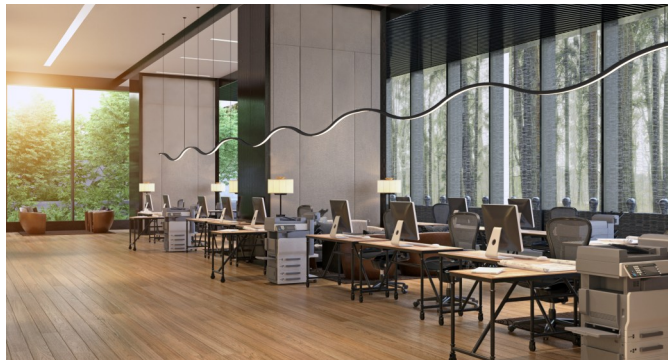

## DIMENSIONS

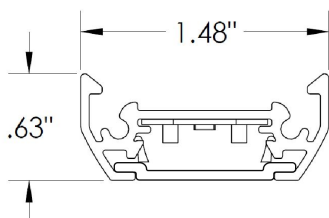

## FEATURES

- ★ Soft diffused direct illumination in a sleek modern minimalist style
- ★ Thermally efficient extruded aluminum single piece housing
- ★ 4' and 8' individual units, or custom lengths
- ★ Powder coat finishes available in white and black
- ★ 0-10v dimming is standard
- ★ Dim to 1% of output current is standard
- ★ 120-277 for power enclosures
- ★ Three power choices of Hyperdrive remote power system
- ★ 90 CRI (R9 50 min) available
- ★ 5 year system warranty
- ★ Class 2 input for luminaire

## DISTRIBUTION

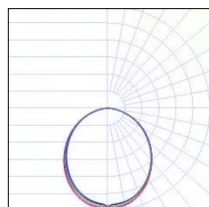

SD= SatinIce Diffuse

See pages 3-5 for additional details



## LUMENS

Based on 3500K CCT. Other CCT available.

MODEL	LUMENS	INPUT WATTS	Lm/W
WAVE-4-1000-SD-35K-80	4000	34	118
WAVE-8-1000-SD-35K-80	8000	65	123

# WAVE

Type:	
Project:	
REP/Agent:	
Order #:	

WAVE						
SERIES	LENGTH	FREQUENCY	LUMENS PER FOOT	DISTRIBUTION	CCT	CRI
WAVE	4= 4FT 8 = 8FT XX= Custom Length	48 = 48" Peak to Peak 96 = 96" Peak to Peak	350= 350LPF 500= 500LPF 750= 750LPF 1000= 1000LPF XX= Custom LPF	SD= Satinice Diffuse	27K= 2700K 30K= 3000K 35K= 3500K 40K= 4000K 50K= 5000K	80= 80 90= 90 (R9 50min)

FINISH	MOUNTING (See Pages 6-8 for Options)	ELECTRICAL
<b>STANDARD</b> <b>PW</b> = Powder Coat White <b>PB</b> = Powder Coat Black  <b>PREMIUM</b> <b>RALxxxx</b> = Powder Coat RALxxxx  See pg. 10 for options.	<b>POWERED CANOPY</b> (Driver included, 120-277V) <sup>3</sup> <b>PCW</b> = Powered Canopy White <b>PCB</b> = Powered Canopy Black  <div style="border: 1px solid black; padding: 5px;"> <b>CANOPY RECESSED</b>  <b>CRW</b>= Canopy Recessed White  <b>CRB</b>= Canopy Recessed Black   <b>CANOPY T-GRID</b>  <b>CTW</b>= Canopy T-Grid White  <b>CTB</b>= Canopy T-Grid Black   <b>CANOPY SURFACE</b>  <b>CSW</b>= Canopy Surface White  <b>CSB</b>= Canopy Surface Black   <b>T-GRID</b><sup>1</sup>  <b>TB1</b>= 9/16" Grid  <b>TB2</b>= 15/16" Grid  <b>TB3</b>= 9/16" Grid  (Tegular)  <b>TB4</b>= 15/16" Grid  (Tegular)   *Items in grey box require Hyperdrive Remote Driver* </div>	<b>1C</b> = Single Circuit <b>MC</b> = Multiple Circuits (multiple switch legs across run length) <b>EC</b> = Emergency Circuit (separate power drops for EC fixtures)

REMOTE OPTIONS	HYPERDRIVE CIRCUIT
<b>Ex</b> = EM Battery designated fixture (Ordered with Hyperdrive) Replace X with battery Qty. Not available with Powered Canopy, Consult factory	<b>HDxx</b> = HyperDrive Circuit Not required for the Powered Canopy configuration

EXAMPLE: WAVE-4-48-750-SD-35K-80-PW-CSW-HD01

EXAMPLE: WAVE-4-750-SD-35K-80-PW-TB1-CRICW-U

<sup>1</sup> Requires Hyperdrive Remote Driver

<sup>2</sup> Tunable White Driver must be specified

<sup>3</sup> 50W Max. Dual driver required

Type:	
Project:	
REP/Agent:	
Order #:	

# HYPER DRIVE REMOTE POWER SYSTEM

HYPD				
SERIES	SIZE / DRIVER QTY	EMERGENCY BATTERY (OPTIONAL)	MOUNTING	FINISH
HYPD	<p>Replace x with driver quantity</p> <p><b>Sx</b>= Small– up to two drivers (190W)</p> <p><b>Mx</b>= Medium– up to four drivers (300W)</p> <p><b>Lx</b>= Large– up to eight drivers (600W)</p>	<p>Replace # with battery quantity</p> <p><b>NB</b>= No Emergency Battery</p> <p><b>#EMB6</b>= 6W EM Battery (Bodine)</p> <p><b>#EMB10</b>= 10W EM Battery (Bodine)</p> <p><b>#FCEMB10</b>= 10W EM Battery (Factory Choice)</p> <p><i>Note: Batteries are only available in Medium and Large enclosures. Each emergency battery reduces the driver quantity of the Hyper Drive.</i></p>	<p><b>S</b>= Surface/ Strut</p> <p><b>R</b>= Recessed</p>	<p><b>STANDARD</b></p> <p><b>PW</b>= Powder Coat White</p> <p><b>PB</b>= Powder Coat Black</p> <p><b>PREMIUM</b></p> <p><b>RALxxxx</b>= Power Coat</p> <p>RAL xxxx (Gloss Finish)</p>

VOLTAGE	OPTIONS	HYPERDRIVE CIRCUIT
U= 120-277	<p><b>SPECIALTY DRIVERS</b> (Standard driver is 0-10V, dim to 1% output current)</p> <p><b>DT1</b>= eldoLED EcoDrive Dim to 1% (0-10V)</p> <p><b>DTZ</b>= eldoLED SoloDrive Dim to 0.1% (0-10V)</p> <p><b>PSRD</b>= Signify Sensor Ready (DALI) Driver</p> <p><b>LDE1</b>= Lutron Hi-Lume EcoSystem LED driver w/ Soft-on, Fade-to-Black</p> <p><b>TW-A</b>= Tunable White, 0-10v</p> <p><b>TW-EL</b>= eldoLED DUALdrive Tunable White (DALI)</p> <p>Consult factory for additional driver options</p> <p><i>Note: Specialty driver options are not available with the small power-box option, with the exception of TW-A</i></p> <p><b>SENSORS</b></p> <p>Consult factory for options</p> <p><b>OTHERS</b></p> <p><b>CP</b>= Chicago Plenum (CCEA)</p>	<p><b>HDxx</b>= HyperDrive Circuit</p>

**EXAMPLE: HYPD-L8-R-PW-DTZ-HD01**

## NOTES & LIMITATIONS

One driver is required per direct only fixture (8' max length)

Consult factory for custom configurations and drivers not listed.

## L8 configuration shown (shown with front cover removed)

Each driver is provided with a terminal block on both input and output side for ease of wiring and installation.

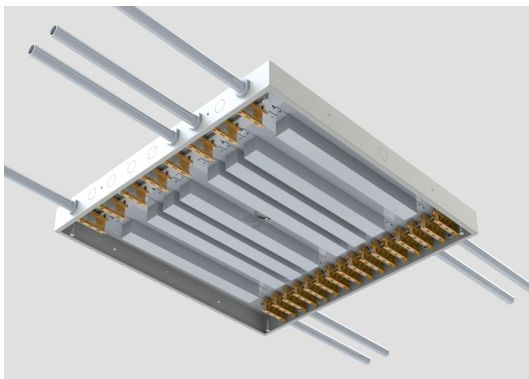

# HYPERDRIVE REMOTE POWER SYSTEM

## Sx (Small Hyper Drive Remote Canopy)

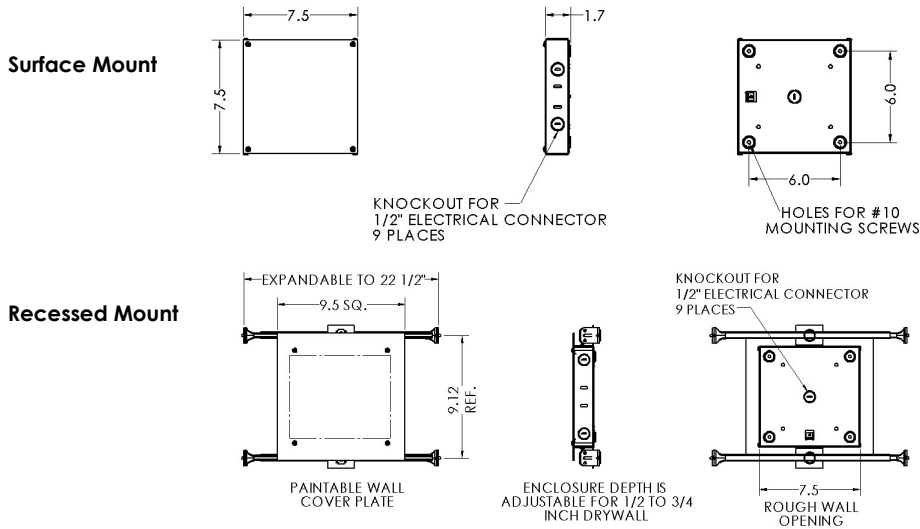

<b>Driver Form Factor</b>	Compact
<b>Input Rating</b>	120-277V
<b>Outputs</b>	Up to 2 (190W max)
<b>Max Remote Distance</b>	Up to 100' (30.5m)
<b>Knockouts</b>	(9) 1/2"
<b>Battery</b>	Not Available

## Mx (Medium Hyper Drive Remote Canopy)

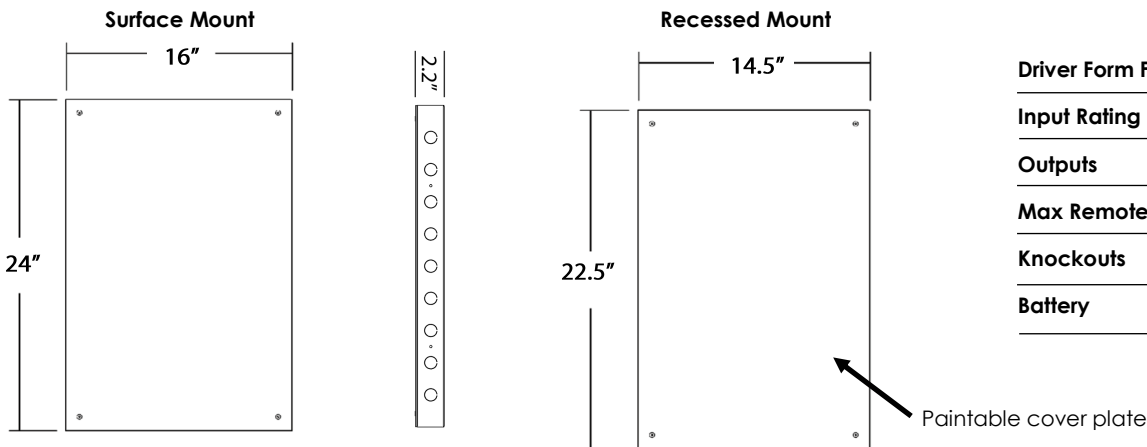

<b>Driver Form Factor</b>	Linear
<b>Input Rating</b>	120-277V
<b>Outputs</b>	Up to 4 (300W max)
<b>Max Remote Distance</b>	Up to 100' (30.5m)
<b>Knockouts</b>	(20) 1/2"
<b>Battery</b>	Available

## Lx (Large Hyper Drive Remote Canopy)

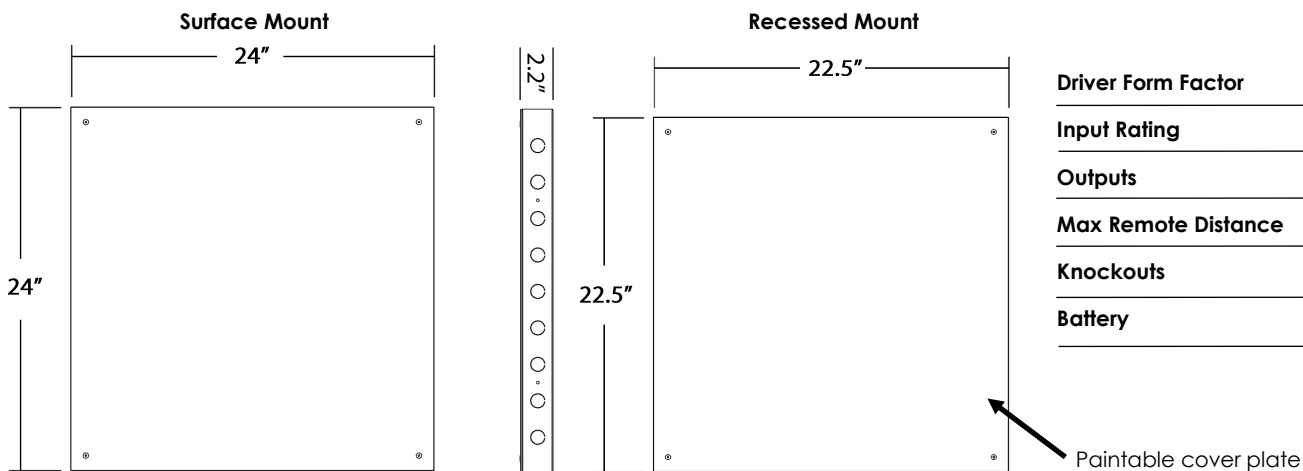

<b>Driver Form Factor</b>	Linear
<b>Input Rating</b>	120-277V
<b>Outputs</b>	Up to 8 (600W max)
<b>Max Remote Distance</b>	Up to 100' (30.5m)
<b>Knockouts</b>	(20) 1/2"
<b>Battery</b>	Available

## How to use this guide

Fill out the worksheet to specify your requirements for your configurations.  
Be sure to callout battery and sensor locations.

Refer to the run chart for standard run configurations on linear lengths,  
consult factory for custom configurations.

Use the order guide to create your BOM for your configuration.

**Submit the worksheet along with your order.**

## #1 Example Bill of Materials

Qty. Type

3	WAVE-8-48-750-SD-35K-80-PW-CSW-HD01	
3	WAVE-4-48-750-SD-35K-80-PW-CSW-HD01	
1	HYPD-L6-NB-R-PW-DTZ-HD01	

## #1 Example Configuration

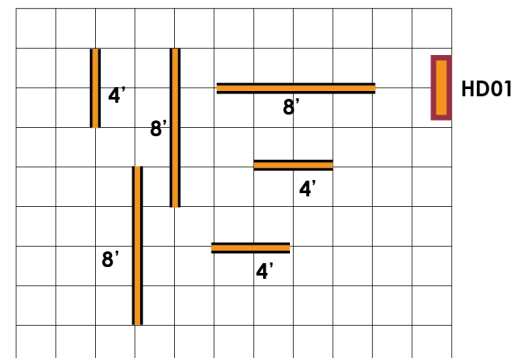

Note: Low Voltage Power transfer wire between fixture and HyperDrive remote power system provided by others.

## #2 Example Bill of Materials

Qty. Type

3	WAVE-8-48-750-SD-35K-80-PW-CSW-HD01	
2	WAVE-6-48-750-SD-35K-80-PW-CSW-HD01	
1	WAVE-2-48-750-SD-35K-80-PW-CSW-HD01	
1	WAVE-10-48-750-SD-35K-80-PW-CSW-HD01	
1	WAVE-6-48-750-SD-35K-80-PW-CSW-E1-HD02	
1	WAVE-10-48-750-SD-35K-80-PW-CSW-HD02	
1	HYPD-L8-NB-R-PW-DTZ-HD01	
1	HYPD-M3-1EMB6-R-PW-DTZ-HD02	

## #2 Example Configuration

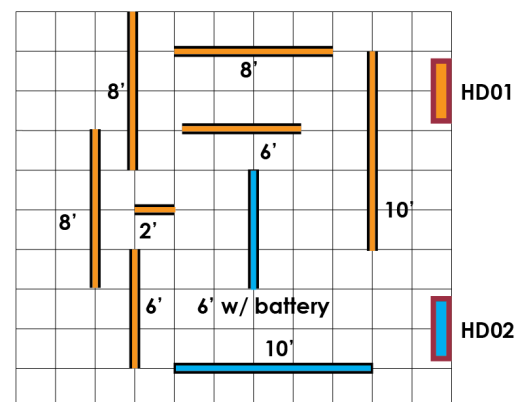

Note: Low Voltage Power transfer wire between fixture and HyperDrive remote power system provided by others.

**2' - 6' Fixtures require 1 Non-Fed Mount. Fixtures larger than 6' require 2 Non-Fed Mount.**

### PCx - Powered Canopy (Driver Included)

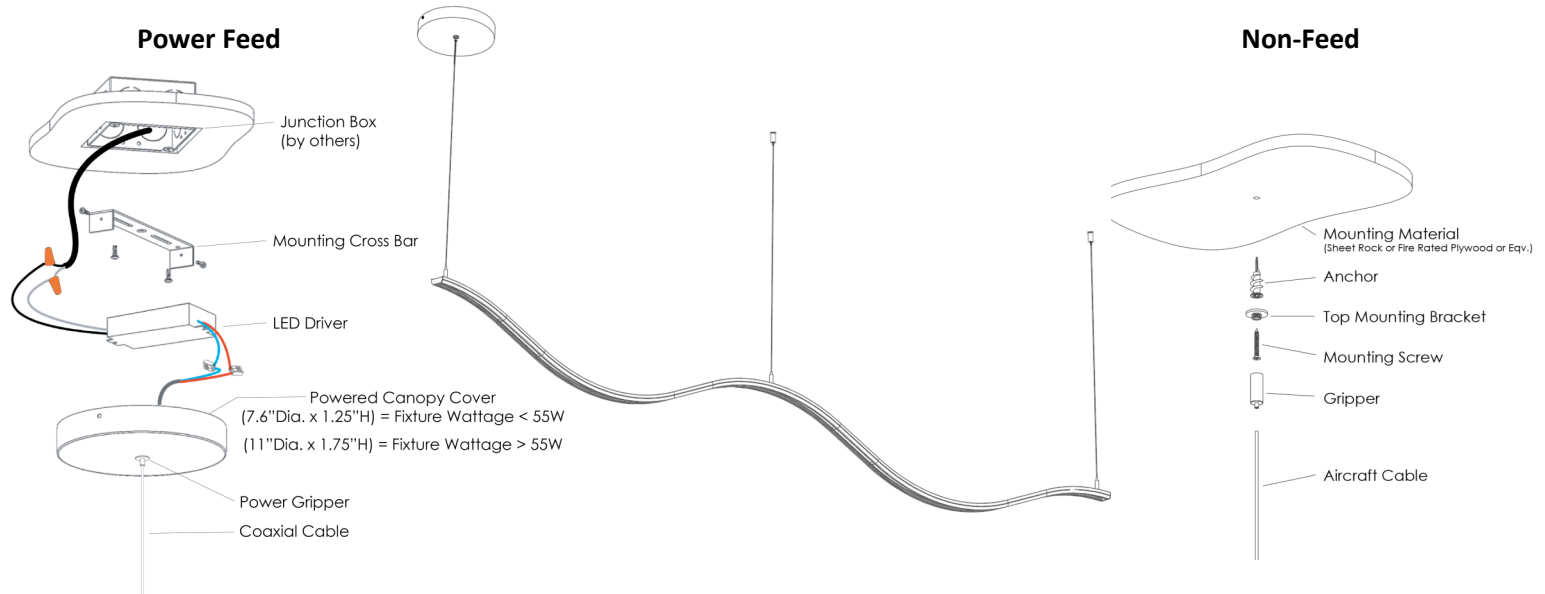

### CRx - Canopy Recessed

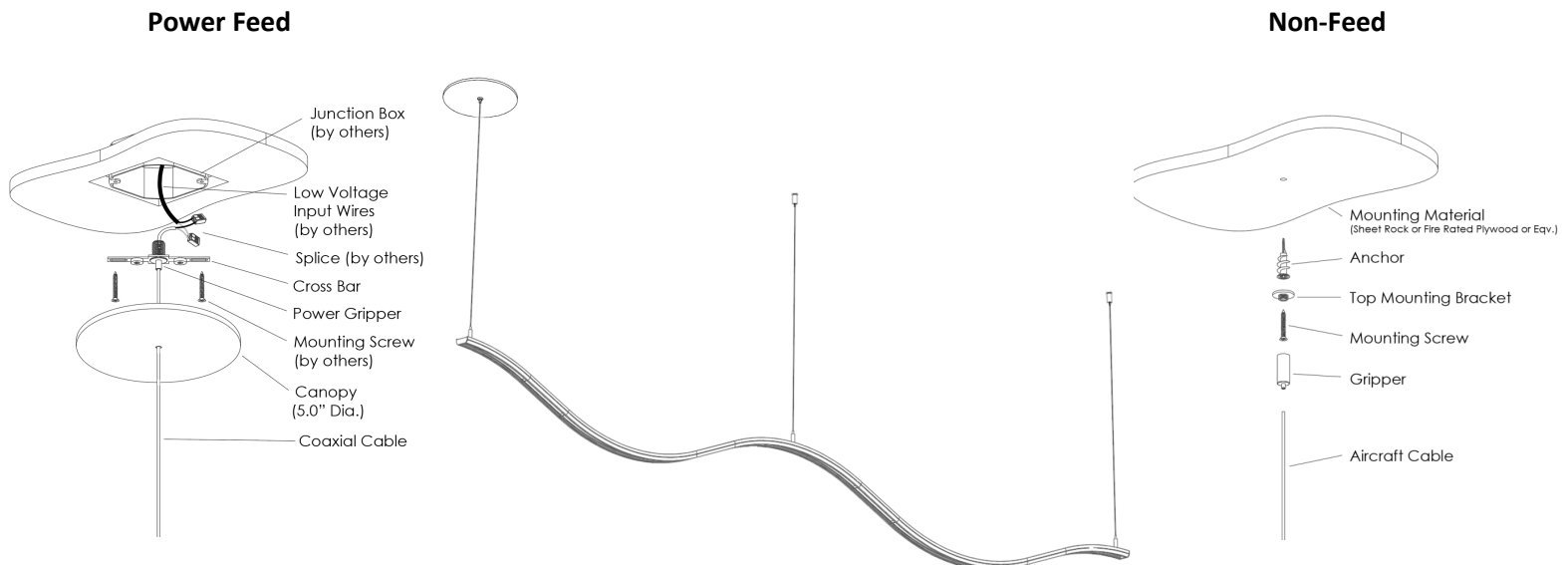

**REQUIRES  
HYPERDRIVE**

### CTx - Canopy T-Grid

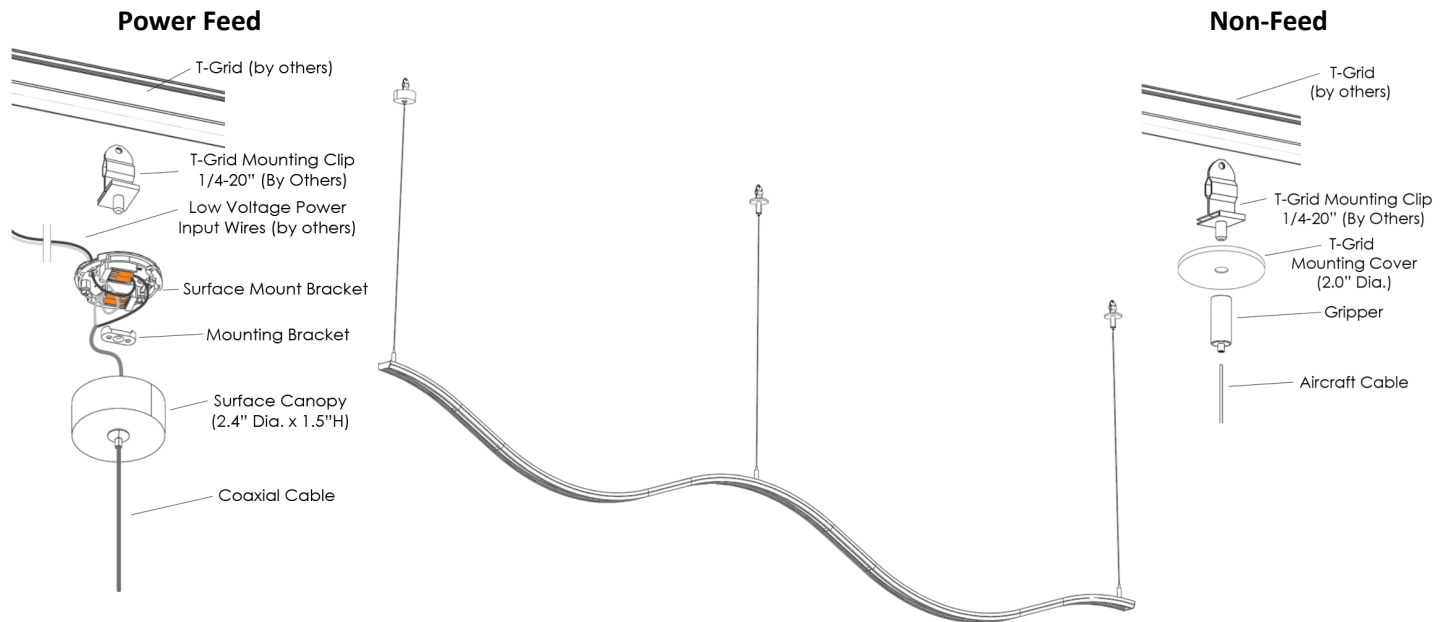

**REQUIRES  
HYPERDRIVE**

### CSx - Canopy Surface

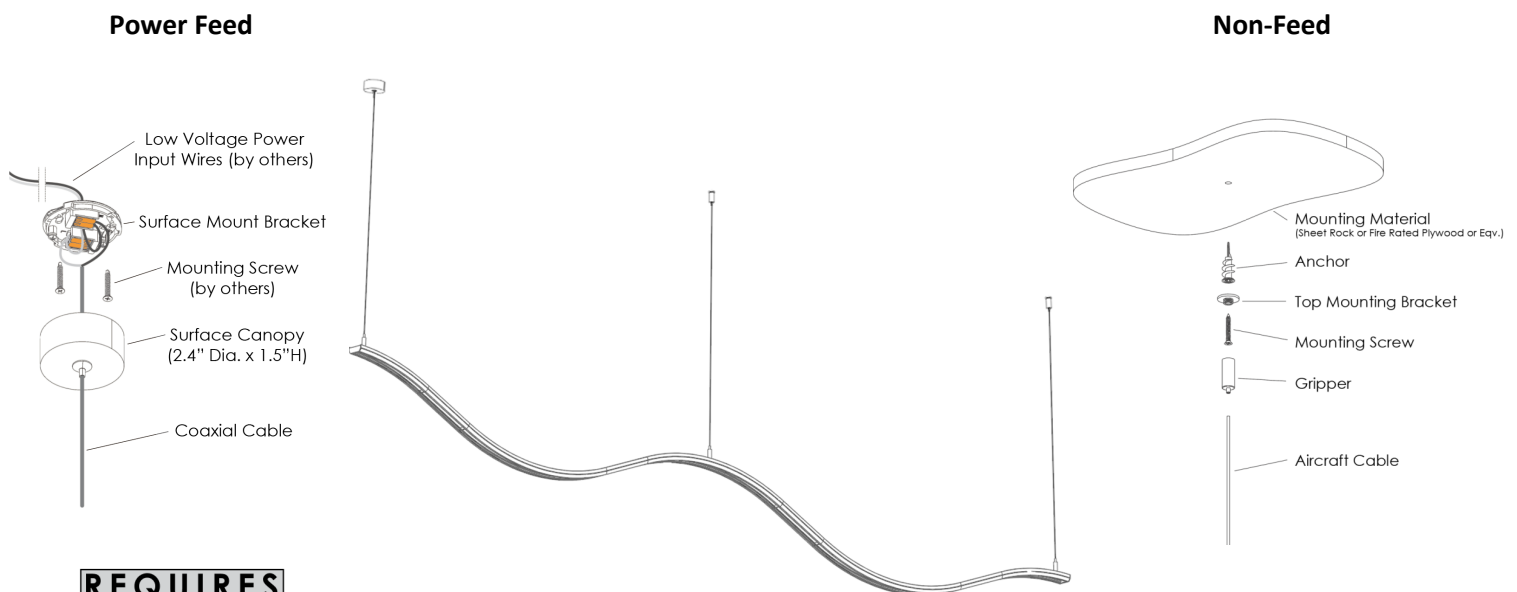

**REQUIRES  
HYPERDRIVE**

# WAVE

## MOUNTING OPTIONS

### TBx - T-Grid

#### Twist Clip Mount

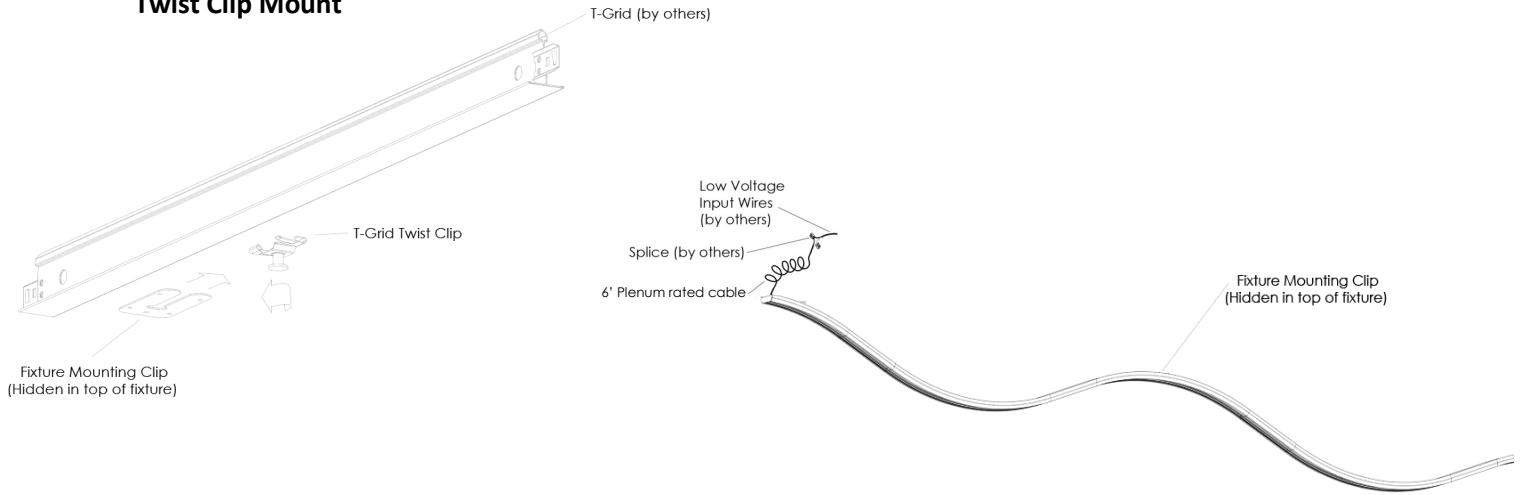

**REQUIRES  
HYPERDRIVE**

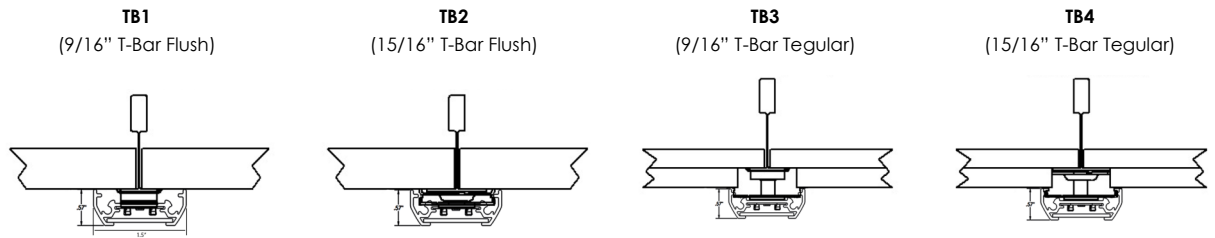

### STEMxx (Stem Mount With Canopy)

Please specify stem length when ordering. See "Stem Lengths" table for available options.

Stem Lengths					
Specified stem length is 3/4" shorter when measured from ceiling to fixture (CtoF).*					
STEMXxx	CtoF	STEMXxx	CtoF	STEMXxx	CtoF
6"	5.25"	24"	23.25"	60"	59.25"
8"	7.25"	27"	26.25"	66"	65.25"
9"	8.25"	30"	29.25"	72"	71.25"
12"	11.25"	36"	35.25"	78"	77.25"
15"	14.25"	42"	41.25"	84"	83.25"
18"	17.25"	48"	47.25"	90"	89.25"
21"	20.25"	54"	53.25"	96"	95.25"

\*Stem Mount can only be placed at Peaks\*

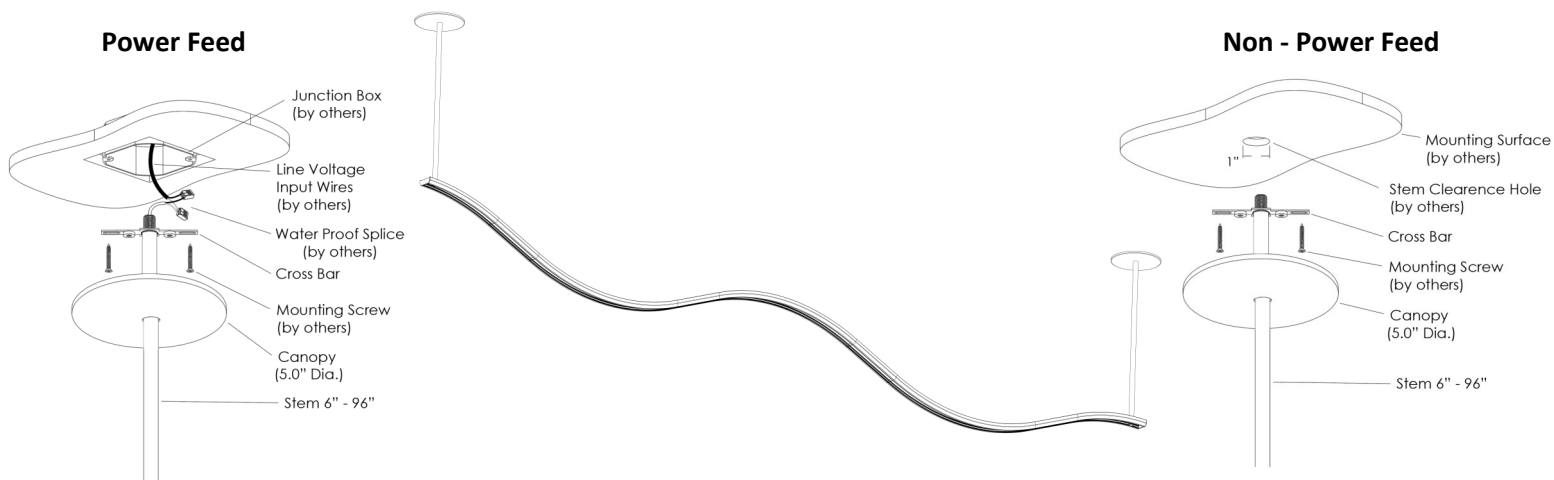
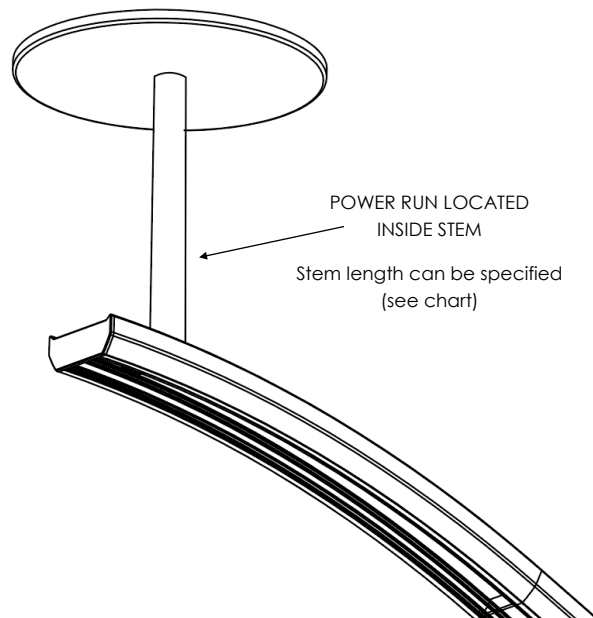

### xx (Run Length)

The standard construction of run lengths follows the logic of the table below. Consult factory for additional information.

Run lengths always start with the longest fixture and receives the power feed.

		Total Length									
		4	8	12	16	20	24	28	32	36	40
# of Sections	2										
	3										
	4	1		1		1		1		1	
	5										
	6										
	7										
	8	0	1	1	2	2	3	3	4	4	5

**NOTE:** Fixtures in continuous runs are available in 4ft increments. Consult factory for custom profiles.

## OVERALL LENGTH/RADIUS DIMENSIONS

### Frequency: 96" Peak to Peak

8 - 96

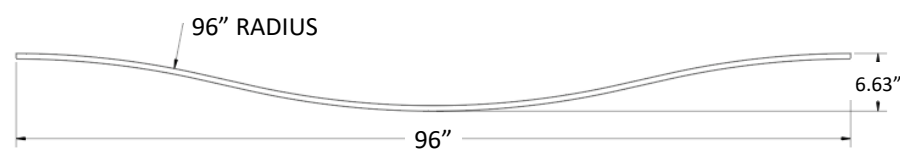

4 - 96

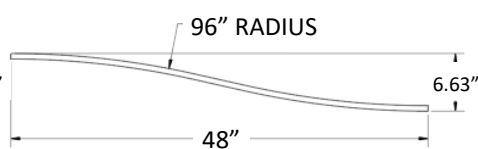

### Frequency: 48" Peak to Peak

8 - 48

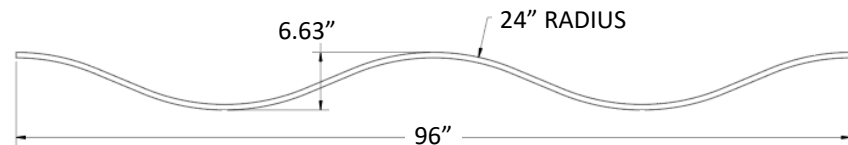

4 - 48

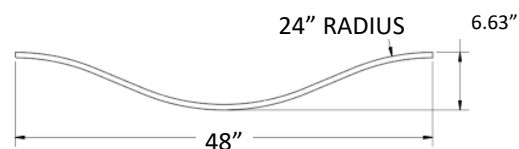

# WAVE

## PERFORMANCE

### WAVE-X-1000-XX (80+ CRI)

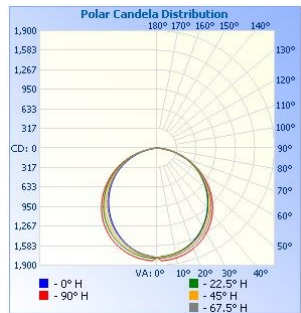

Model	Lumens	Watts	LPW
WAVE-4-1000-SD-30K-80	4000	36	110
WAVE-4-1000-SD-35K-80	4000	34	118
WAVE-4-1000-SD-40K-80	4000	33	120
WAVE-4-1000-SD-50K-80	4000	32	122

Model	Lumens	Watts	LPW
WAVE-8-1000-SD-30K-80	8000	70	114
WAVE-8-1000-SD-35K-80	8000	65	122
WAVE-8-1000-SD-40K-80	8000	64	124
WAVE-8-1000-SD-50K-80	8000	63	126

## FINISHES

### STANDARD FINISHES



SATIN WHITE

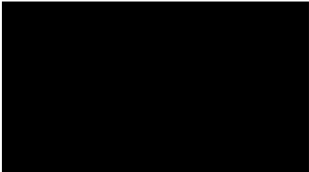

SATIN BLACK

# WAVE

## SPECIFICATIONS

### Housing

Nominal 5/8" x 1 1/2" rectangular housing of continuous extruded 6063 T5 aluminum.

### Color

Colors for the housing are available in a powder coated white or black with end cap to match. Consult factory for custom colors.

### Luminaire Length

4' or 8' lengths are available for a single stand-alone section.

### End Caps

Machined Aluminum flat end caps are mechanically attached with no exposed fasteners to enhance architectural aesthetic and prevent light leak.

### Source

Lumen packages are available in four color temperature options (3000K, 3500K, 4000K and 5000K) — all within 2.5 MacAdam ellipses.

### Certification

RoHS (Restriction of Hazardous Substances) and Buy American Act compliant.

### Battery

Lithium ion battery providing up to 780lm(6W) or up to 1300lm(10W) for 90 minutes. UL924 listed. Class 2 compliant. Meets Title 20 CEC (California Energy Commission) efficiency standards.

### Environment

Suitable for dry and damp locations.  
Operating temp.: -40°C to +50°C  
-40°F to +122°

### Dimming

UL listed, class P (0-10V) dimming driver with programmable current for configurable fixture lumen outputs.  
2.5 KV overcurrent protection  
Power factor >.9

### Packaging

Sustainably manufactured outside cardboard box and biodegradable, protective poly-foam luminaire inserts.

## COMPANION PRODUCTS

### Micro Beam

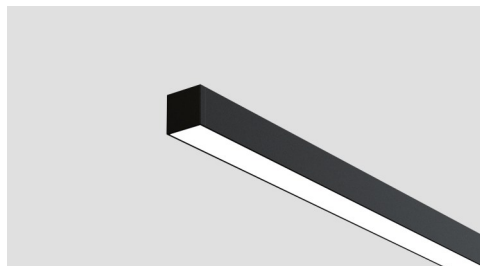

### Micro Optimo

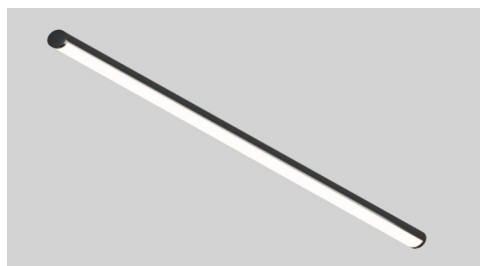

## WARRANTY

5-year limited warranty. Complete warranty terms can be located at:

[http://www.starteklightingamerica.com/images/pdf/warranty/MicroFlat\\_Series\\_Warranty.pdf](http://www.starteklightingamerica.com/images/pdf/warranty/MicroFlat_Series_Warranty.pdf)

Note: Actual performance may differ as a result of installation environment and final application.  
All values are design or typical values, measured under laboratory conditions, at 25°C (77°F) .