

Type:	
Project:	
REP/Agent:	
Order #:	

AQUA SLIM DIRECT

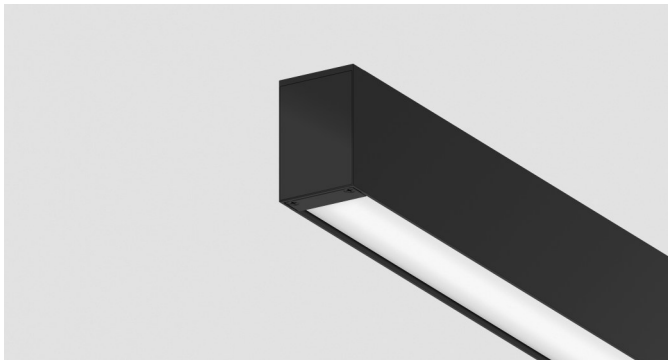

DIMENSIONS

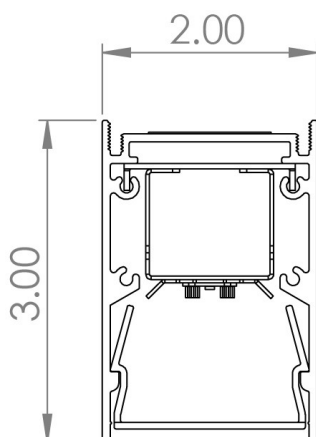

FEATURES

- ★ 2', 3', 4', 6' and 8' individual units, or continuous row
- ★ No visible fasteners
- ★ Efficacy up to 130 lm/W
- ★ Soft diffuse indirect lighting
- ★ Outdoor powder coat finishes available in white, black, silver and bronze
- ★ Premium finishes available
- ★ 0-10v dimming is standard**
- ★ Dim to 1% of output current is standard
- ★ 90 CRI (R9 50min) available
- ★ CA Title 24 / JA8 installation compatible
- ★ Wet location rated

DISTRIBUTION

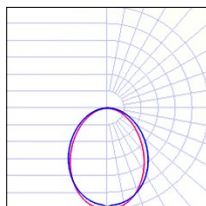

SD= SatinIce Diffuse

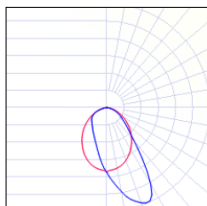

WW= Wall Wash

LUMENS

MODEL	LUMENS	INPUT WATTS	Lm/W
SAQUAD-4-750 SD-35K	3,000	29	104
SAQUAD-8-750-SD-35K	6,000	56	107



Type:	
Project:	
REP/Agent:	
Order #:	

AQUA SLIM DIRECT

SAQUAD				
SERIES	LENGTH	LUMENS/FT	DISTRIBUTION	CCT
SAQUAD	2= 2Ft	350= 350 LPF	SD= Satin Ice Diffuse WW= Wall Wash	27K= 2700K
	3=3Ft	500= 500 LPF		30K= 3000K
	4=4Ft	750= 750 LPF		35K= 3500K
	6=6Ft	1000= 1000 LPF		40K= 4000K
	8=8Ft	XXX= Custom LPF		50K= 5000K
	xx=Run length			
	Sxx= Symmetric Run Length			

CRI	FINISH	MOUNTING	VOLTAGE	ELECTRICAL
80= 80	STANDARD	SURFACE MOUNTS	U= 120-277	1C= Single Circuit
90= 90 (R9 50 min)	PW= Powder Coat White	SM(T)= Surface Mount (Top-fed power)		MC= Multiple Circuits (multiple switch legs across run length)
	PB= Powder Coat Black	SM(E)= Surface Mount (End-fed power)		EC= Emergency Circuit (separate power drops for EC fixtures)
	PS= Powder Coat Silver	SM(S)= Surface Mount (Side-fed power)		
	PBR= Powder Coat Bronze			
	PREMIUM	WALL MOUNTS		
	RALxxxx= Powder Coat	WM= Wall Mount		
	RAL xxxx (Gloss Finish)			
	PSFx= Prem Stock Finish	STEMS WITH CANOPY KITS		
	CUSTOM	STEMWxx= Stem White, xx"		
	PO= Powder Other	STEMBxx= Stem Black, xx"		

OPTIONS

BATTERIES (# indicates quantity)
#EMB10= 10W EM Battery (Iota/Bodine)

SURGE PROTECTOR
SRG= Surge Protector

SENSORS
MLR= Motion Sensor Large Range**

* Emergency battery option not available with 2' fixtures

** Motion sensor option removes dimming ability

EXAMPLE: SAQUAD-8-1000-SD-35K-80-PW-SMT-U-1C-1EMB10

AQUA SLIM DIRECT

INDIVIDUAL FIXTURE CONFIGURATION—SURFACE MOUNT

SM - Surface Mount Configurations

Power Feed Inlet locations

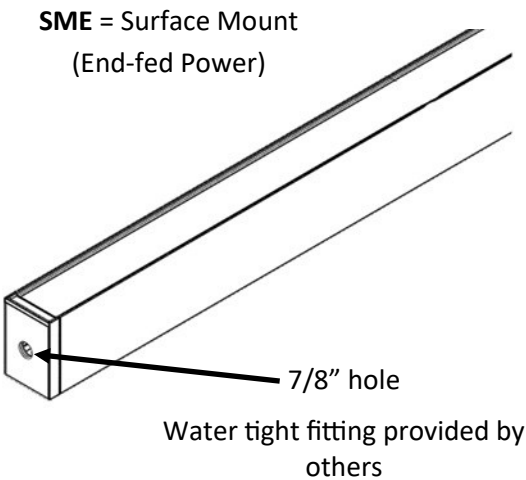
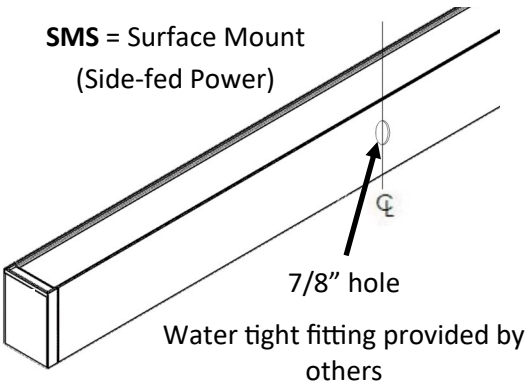
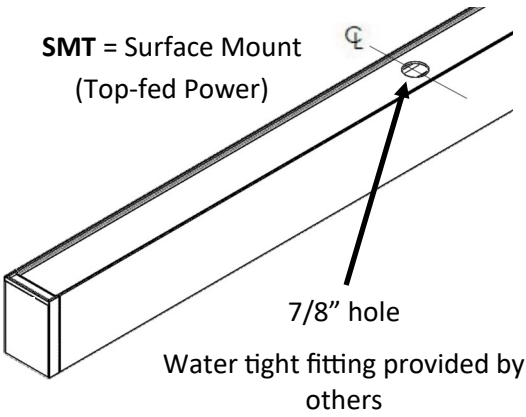

Surface Mount Exploded View

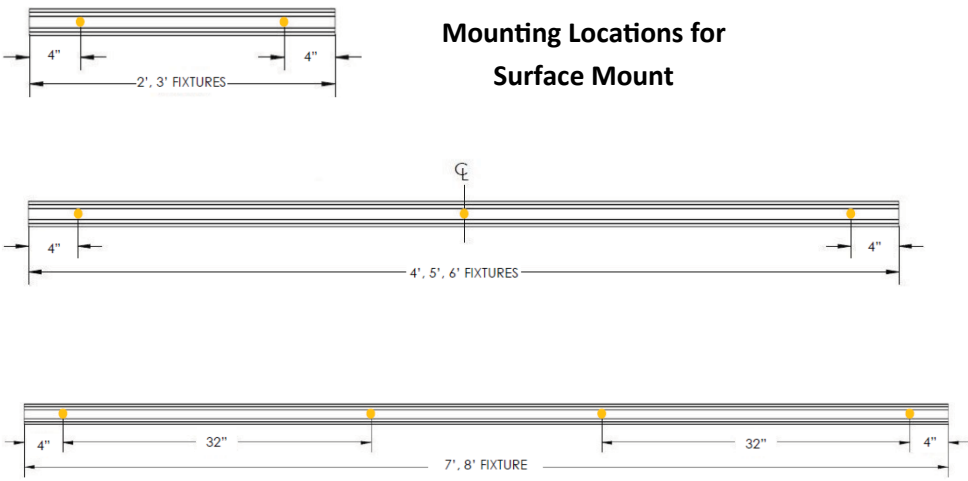
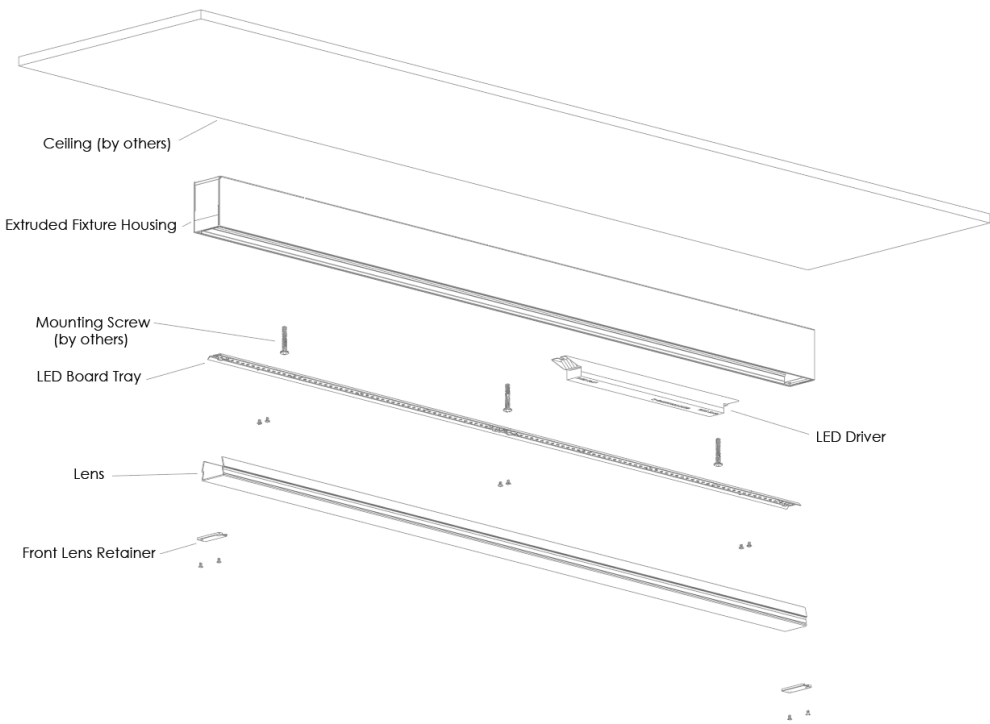

NOTE: Hole size at mounting locations is $\varnothing.266"$.

AQUA SLIM DIRECT

INDIVIDUAL FIXTURE CONFIGURATION—SURFACE MOUNT

WM - Wall Mount Configurations

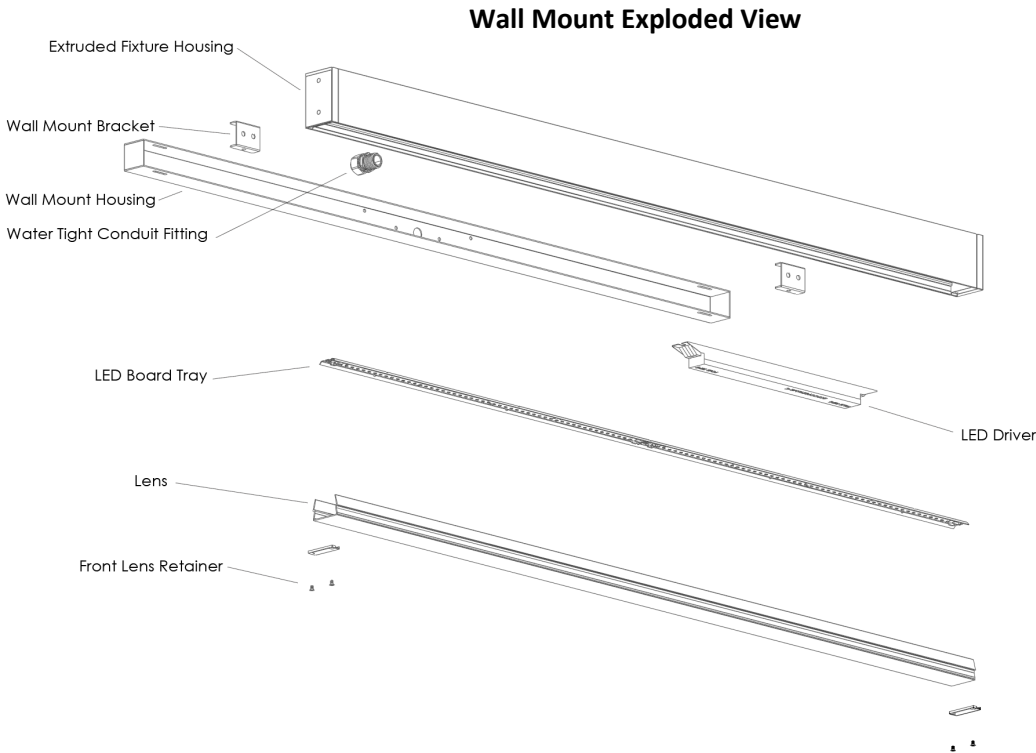

INDIVIDUAL FIXTURE CONFIGURATION—STEM MOUNT

STEM - Stem Mount Configurations

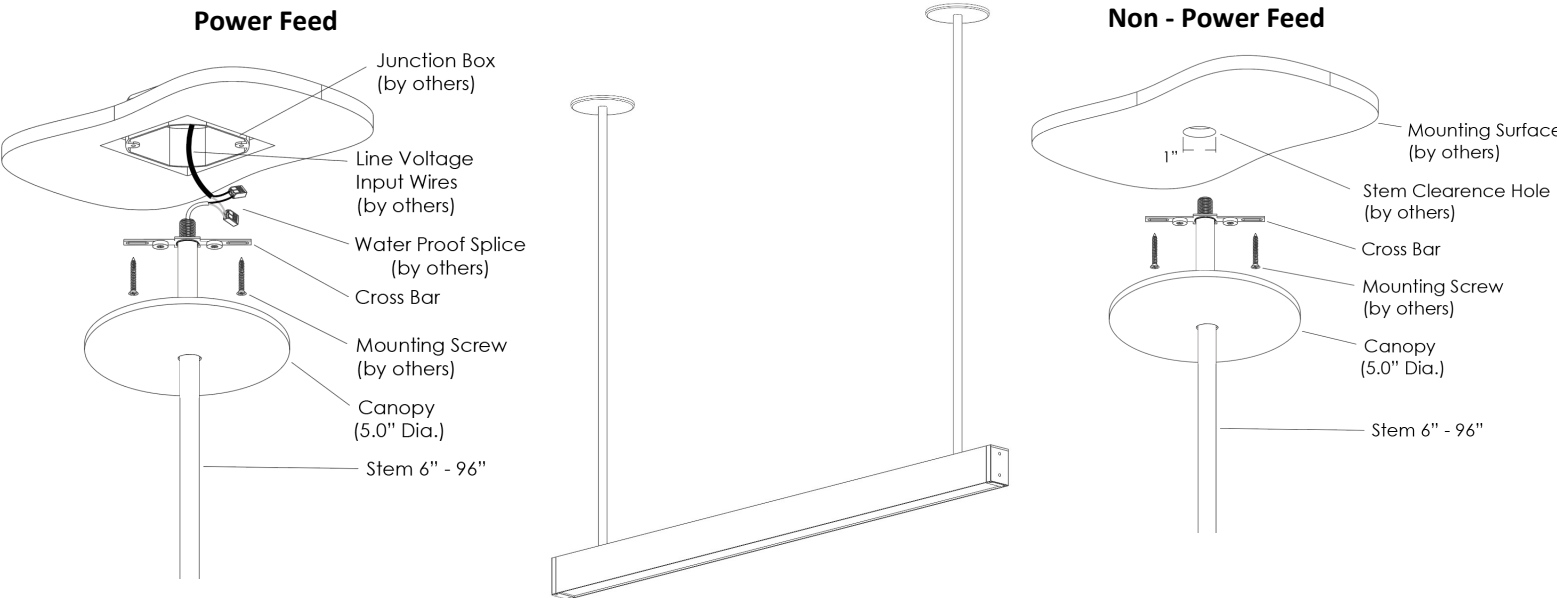

ROW CONFIGURATIONS

xx (Run Length)

The standard construction of run lengths follows the logic of the table below. Consult factory for additional information.

Run lengths always start with the longest fixture and receives the power feed.

		Total Length																																							
		2	3	4	5	6	7	8	9	10	11	12	13	14	15	16	17	18	19	20	21	22	23	24	25	26	27	28	29	30	31	32	33	34	35	36	37	38	39	40	
# of Sections	2	1																																							
	3		1																																						
	4			1					1	1	1	1					1	1	1	1					1	1	1	1					1	1	1	1					
	5				1				1				1				1				1				1				1				1				1				
	6					1				1				1				1				1				1				1				1				1			
	7						1				1				1				1				1				1				1				1				1		
	8							1				1	1	1	1	1	2	1	1	1	2	2	2	2	3	2	2	2	3	3	3	3	4	3	3	3	4	4	4	4	5

NOTE: Fixtures in continuous runs are available in 6" increments. Consult factory for smaller increments.

Sxx (Symmetric Run)

The construction of Sxx (y') is to build with equal length fixtures. The xx indicates the run length. The y' indicates the fixture length used to create the run. Please indicate this on your P.O. when placing your order. NOTE: Each fixture has two end caps; starting end cap is .5" and the joining endcap is .25" (the space between fixtures is .5" total) so the actual length differs from the ordered length. Please make note of the Total Length Formula (Run length= ordered length + 1" + (Fixture joint# (* .5)) & refer to examples below.

EXAMPLE S10: 10 + 1" + (1 (* .5)) = 10' 1-1/2" total run

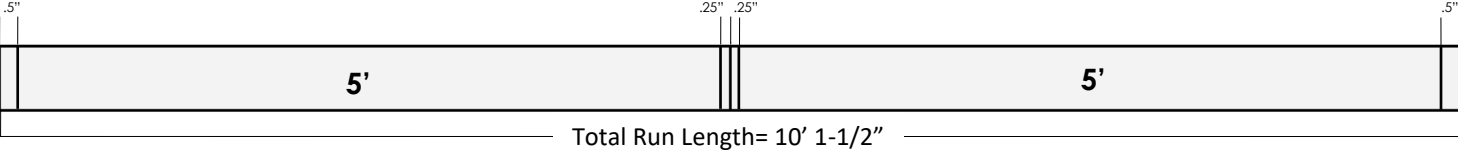

EXAMPLE S12: 12 + 1" + (2 (* .5)) = 12' 2" total run length

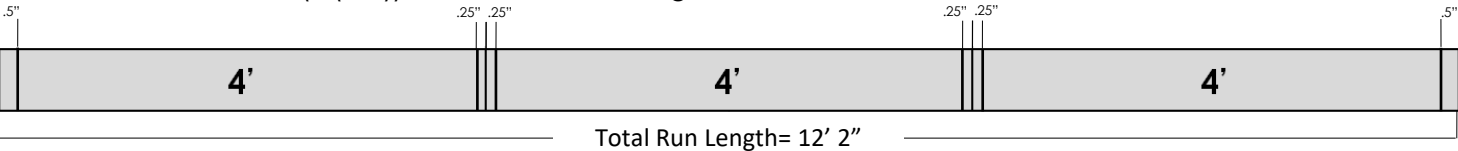

EXAMPLE S16: 16 + 1" + (1 (* .5)) = 16' 1-1/2" total run

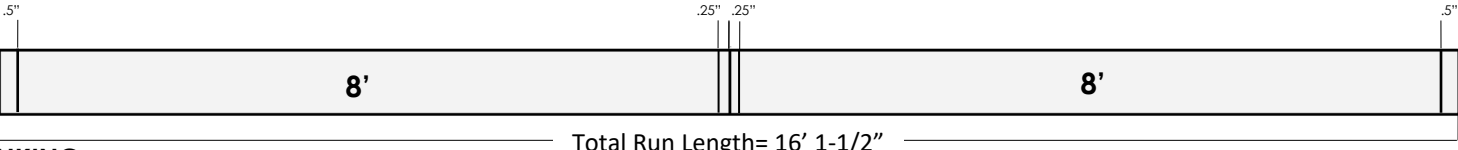

LINKING

Typical continuous run installation shown below.

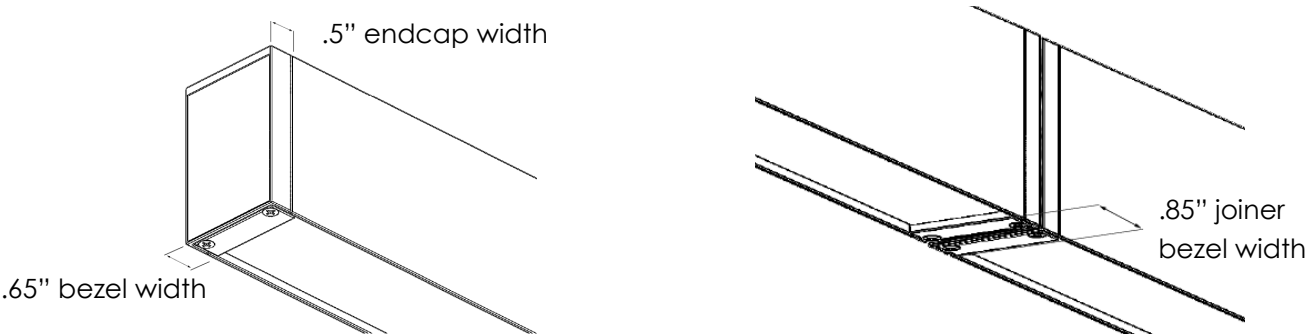

AQUA SLIM DIRECT

PERFORMANCE

AQUA-X-1000-SD (80+ CRI)

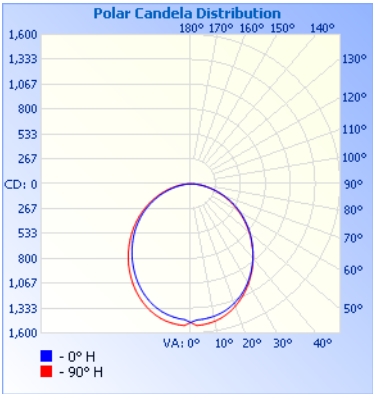

Model	Lumens	Watts	LPW
SAQUAD-4-1000-SD-30K	4,000	35	115
SAQUAD-4-1000-SD-35K	4,000	34	118
SAQUAD-4-1000-SD-40K	4,000	33	121
SAQUAD-4-1000-SD-50K	4,000	32	126

Model	Lumens	Watts	LPW
SAQUAD-8-1000-SD-30K	8,000	67	119
SAQUAD-8-1000-SD-35K	8,000	65	122
SAQUAD-8-1000-SD-40K	8,000	64	125
SAQUAD-8-1000-SD-50K	8,000	62	130

WIRING DIAGRAMS

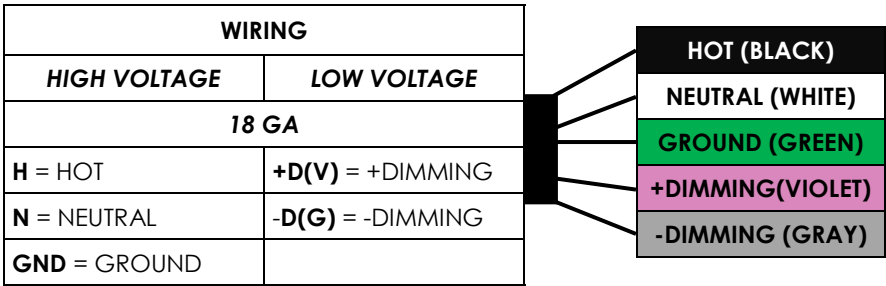

This wiring diagram is showing a standard set of wires for a basic fixture.

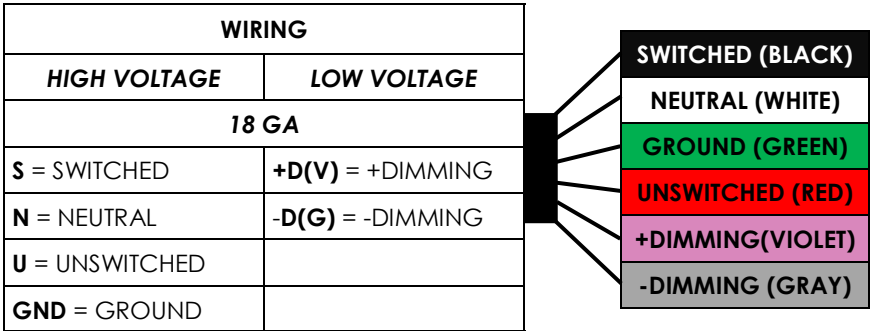

This wiring diagram is showing a set of wires for a fixture with a emergency battery.

AQUA SLIM DIRECT

SPECIFICATIONS

Housing Nominal 2" x 3 " rectangle housing of continuous extruded 6063 T5 aluminum.	Source Four standard lumen packages are available in four color temperature options (3000K, 3500K, 4000K and 5000K) — all within 3 MacAdam ellipses.	Dimming Driver Constant current programmable LED driver. UL listed, class P, 0-10V, dim to 1% of output current. 2.5KV ring wave surge protection and >.90 power factor.
Luminaire Length 2', 4', 6' or 8' lengths are available for a single stand-alone section. Using internal joiners, sections can be joined to form longer rows.	Certification Intertek cETLus Listed. RoHS (Restriction of Hazardous Substances) and Buy American Act compliant.	Packaging Sustainably manufactured outside cardboard box and biodegradable, protective poly-foam luminaire inserts.
Battery Lithium ion battery providing up to 720lm(6W) or up to 1200lm(10W) for 90 minutes. UL924 listed. Class 2 compliant. Meets Title 20 CEC (California Energy Commission) efficiency standards.	Environment Suitable for dry and damp locations. Operating temp.: -40°C to +45°C	
Lensing Snap-in .080" thick acrylic lensing with impact modifier		

CONTROL

Sensor

Wattstopper FS-205 v2 Low Voltage PIR. Integrated photosensor for hold-off daylighting control. 24VDC operating voltage. Adjustable time delay (30 seconds to 30 minutes).

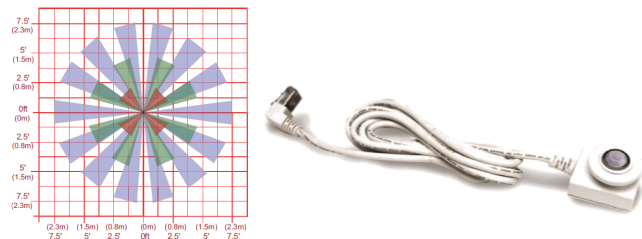

Wireless Node



COMPANION PRODUCTS

Beam Direct



Beam Direct/Indirect



WARRANTY

5-year limited warranty. Complete warranty terms can be located at:

http://www.starteklightingamerica.com/images/pdf/warranty/Beam_Series_Warranty.pdf

Note: Actual performance may differ as a result of installation environment and final application.
All values are design or typical values, measured under laboratory conditions, at 25°C (77°F) .