

Type:	
Project:	
REP/Agent:	
Order #:	

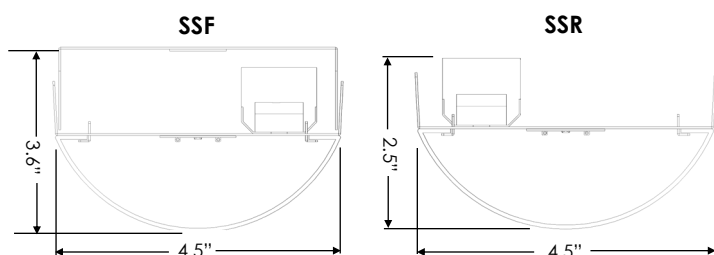

DIMENSIONS



ORDERING LOGIC (Full fixture)

SERIES	LENGTH	OUTPUT	CCT (80+ CRI)	FINISH	MOUNTING**	OPTIONS
SSF= Full fixture	2= 2' 3= 3' 4= 4' 6= 6' 8= 8' 16= 16' XX= Run	S= Standard H= High	30K= 3000K 35K= 3500K 40K= 4000K 50K= 5000K Higher CRI/R9 options available	PW= Powder Coat White PO= Powder Coat Other* *Custom colors will require that the factory be provided with and RAL# or color chip	SM= Surface Mount P05= Yolk and Toggle Kit (5') P10= Yolk and Toggle Kit (10')	MSI= Microwave Sensor (internal) DME= Daylight/Motion Sensor (external) EMB06= 6W EM Battery EMB10= 10W EM Battery EMB15= 15W EM Battery NPx= Nema Plug (Various) GTD= Generator Transfer Device

EXAMPLE: SSF-4S-35K-PW-SM-EMB10

** See mounting details on page 2.

ORDERING LOGIC (Retrofit)

SERIES	LENGTH	OUTPUT	CCT (80+ CRI)
SSR=Retrofit	2= 2' 3= 3' 4= 4' 8= 8' 16S= 16'	S= Standard H=High	30K= 3000K 35K= 3500K 40K= 4000K 50K= 5000K Higher CRI/R9 options available

EXAMPLE: SSR-4S-35K

FEATURES

- Strip retrofit or complete fixture
- Retrofit compatible with housing widths between 4 1/4" and 4 3/8"
- Units available in 2', 3', 4', 6', 8' and a 16' tandem fixture (1 driver for 16' of fixture)
- Two standard lumen packages available
- Efficacy up to 166 lm/W
- Soft diffuse direct lighting
- Approved for dry and damp locations
- 0-10v dimming is standard
- Dim to 1% of output current
- Available in 120V-277V only



LUMEN PACKAGES

Based on 3500K CCT. Other CCT available.

MODEL	LUMENS	INPUT WATTS	Lm/W
SSx-4S-35K	3,221	22.6	143
SSx-8S-35K	6,656	44.9	148
SSx-16S-35K	13,703	86.1	159

SSx-16S CONFIGURATION

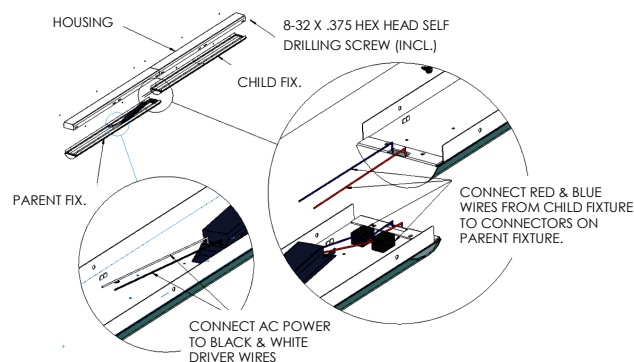

Type:	
Project:	
REP/Agent:	
Order #:	

MOUNTING OPTIONS

SM

Surface mounting is achieved by securing fixture housing to drywall with contractor provided anchors and screws through openings in housing back.

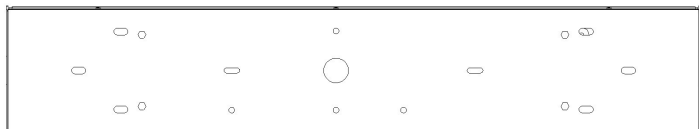

SM=Surface Mount

P05=Universal Yolk and Toggle Kit (5')

P10=Universal Yolk and Toggle Kit (10')

PXX

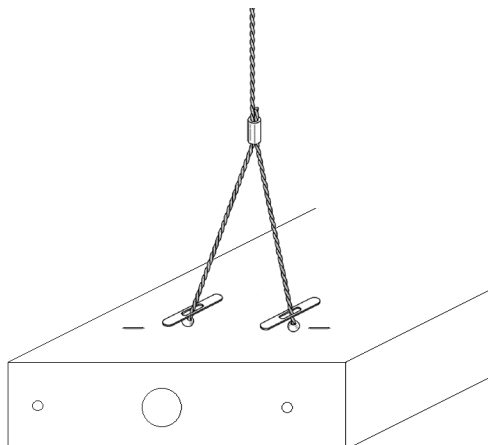

DIMENSIONS

MODEL	NOMINAL LENGTH	LUMINAIRE LENGTH	WEIGHT (SSR)	WEIGHT (SSF)
SSX-2	2 ft.	24.0" (610mm)	3 lbs. max (1.4 kg)	5 lbs. max (2.3 kg)
SSX-3	3 ft.	36.0" (914mm)	4.5 lbs. max (2.0 kg)	7.5 lbs. max (3.4 kg)
SSX-4	4 ft.	48.0" (1,219mm)	6 lbs. max (2.7 kg)	10 lbs. max (4.5 kg)
SSX-8	8 ft.	96.0" (2,348mm)	12 lbs. max (5.4 kg)	20 lbs. max (9.1 kg)
SSX-16	16 ft.	192.0" (4,877mm)	24 lbs. max (10.8 kg)	35 lbs. max (16.4 kg)

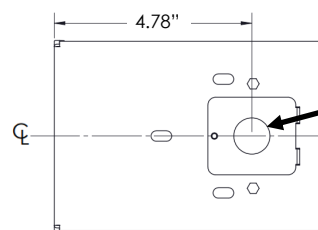

Standard
Power
Location
(Top)

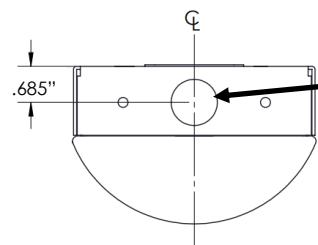

Alternate
Power
Location
(End)

Please consult factory if **End** configuration is desired.

Type:	
Project:	
REP/Agent:	
Order #:	

PERFORMANCE

STANDARD OUTPUT - 80+ CRI

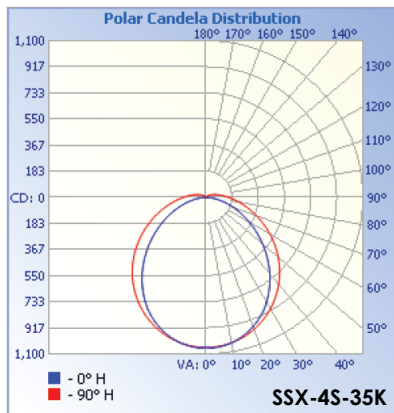

Model	Lumens	Watts	LPW
SSx-2S-35K	1,611	12.4	129.6
SSx-2S-40K	1,675	12.5	134.1
SSx-2S-50K	1,803	12.5	144.4

Model	Lumens	Watts	LPW
SSx-3S-35K	2,416	17.4	138.8
SSx-3S-40K	2,512	17.5	143.7
SSx-3S-50K	2,705	17.5	154.7

SSx-4S-35K	3,221	22.6	142.8
SSx-4S-40K	3,349	22.7	147.4
SSx-4S-50K	3,606	22.7	158.6

SSx-8S-35K	6,656	44.9	148.2
SSx-8S-40K	6,911	45.6	151.5
SSx-8S-50K	7,424	45.4	163.4

SSx-16S-35K	13,703	86.1	159.1
SSx-16S-40K	13,907	86.2	161.4
SSx-16S-50K	14,316	86.2	166.1

HIGH OUTPUT - 80+ CRI

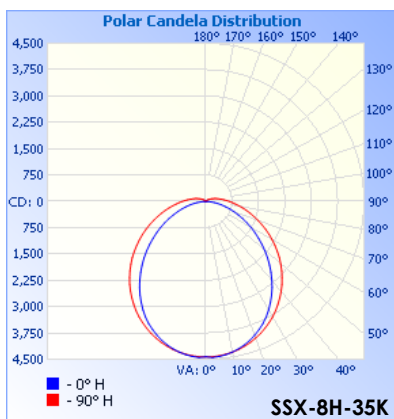

Model	Lumens	Watts	LPW
SSx-2H-35K	3,381	24.8	136.6
SSx-2H-40K	3,423	24.7	138.4
SSx-2H-50K	3,506	24.7	142.1

Model	Lumens	Watts	LPW
SSx-3H-35K	5,072	35.4	143.4
SSx-3H-40K	5,135	35.3	145.4
SSx-3H-50K	5,259	35.5	149.2

SSx-4H-35K	6,763	47.2	143.4
SSx-4H-40K	6,846	47.1	145.4
SSx-4H-50K	7,013	47.0	149.2

SSx-8H-35K	13,525	94.3	143.4
SSx-8H-40K	13,692	94.2	154.3
SSx-8H-50K	14,025	94.0	149.2

Type:	
Project:	
REP/Agent:	
Order #:	

SPECIFICATIONS

Housing

Nominal 4 1/2" wide, 22ga cold rolled steel.

Color

Housings are standard in a powder coat white finish. Custom powder coat options are available. Consult factory.

Luminaire Length

Fixtures are available in 2', 3', 4', 8' and 16' lengths (see dimensions chart page 2).

Source

Two lumen packages are available in three color temperature options (3500K, 4000K and 5000K) — all within 3 MacAdam ellipses.

Dimming Driver

Universal Lighting Technologies (ULT) Everline series of LED drivers allows tunable output currents to achieve infinite configurations of output. UL Class 2 recognized. 0-10v interface can be wired as Class 1 or Class 2 circuit. Included 2.5Kw ring and wave overcurrent protection, isolation of each individual output and a fully potted driver to protect from heat and vibration.

Certification

Intertek cETLus Listed. RoHS (Restriction of Hazardous Substances) and Made in USA.

Environment

Suitable for dry and damp locations.
Operating temp.: -40°C to +50°C
-40°F to +122°F
Power Factor: <.96

Battery

Philips Bodine lithium ion battery providing up to 780lm(6W) or up to 1300lm(10W) for 90 minutes. UL924 listed. Class 2 compliant. Meets Title 20 CEC (California Energy Commission) efficiency standards.

Packaging

Sustainably manufactured outside cardboard box and biodegradable, protective poly-foam luminaire inserts.

CONTROL

Sensor (MSI - Preferred)

The LMS-109 is a line voltage occupancy sensor designed for integrating with OEM luminaire to provide occupancy sensing based on/off switching control. This occupancy sensor utilizes the advanced High Frequency Doppler (HFD) technology which is capable of detecting the occupant's presence and movement through non-metallic enclosure, such as plastic cover or diffuser.

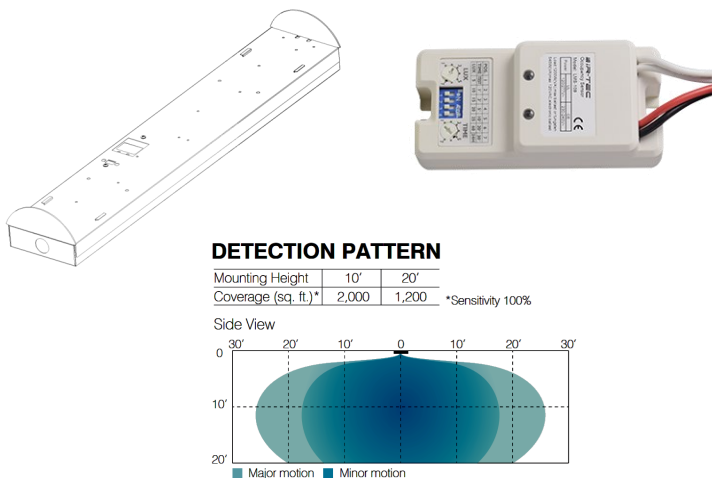

Sensor (DME)

Optional passive infrared motion and daylight sensor activates switching of luminaire on/off. Standard Factory settings: Luminaire is activated and increased to full bright upon detection of motion. Luminaire powers off when target zone is absent of motion activity for ~5 minutes. See coverage diagram for detection cone. Not available with decorative endcap accessory.

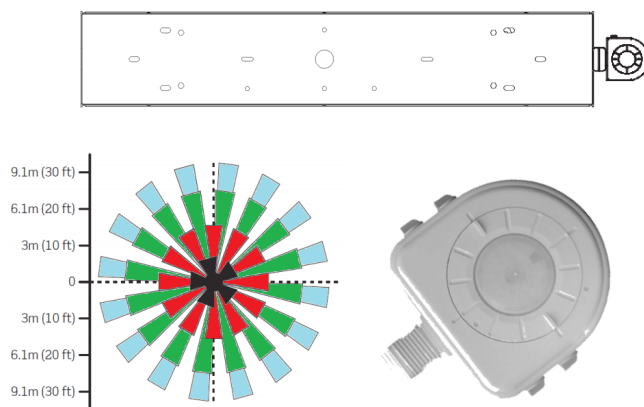

WARRANTY

5-year limited warranty. Complete warranty terms can be located at:

http://www.starteklightingamerica.com/images/pdf/warranty/StarStrip_Warranty.pdf

Note: Actual performance may differ as a result of installation environment and final application.
All values are design or typical values, measured under laboratory conditions, at 25°C (77°F) .